



Dimensions for washers and rings

Plain washers (round)

Nominal size = screws/pins		DIN 1052 (Pk C) -			DIN 1440 (Pk C) DIN 1441 (Pk C)*			DIN 988 -S (Pk C) -			Note
M/Ø	Ww	d ₁	d ₂	h	d ₁	d ₂	h	d ₁	d ₂	h	
35					35	52	6	35	45	2.5	Washers in special design - punched – turned – burned – in all sizes and materials on request
36	*1 3/8"				36 (37)	52	6				
37								37	47	2.5	
40					40 (41)	58	6	40	50	2.5	
45	*1 3/4"				45 (46)	62	7	45	55	3	
50					50 (51)	68	8	50	62/63	3	
55					55 (56)	75	9	55	68	3	
60					60 (62)	80	9	60	75	3	
63								63	80	3	
65					65 (68)	90	9	65	85	3.5	
70					70 (72)	95	10	70	90	3.5	
75					75 (78)	100	10	75	95	3.5	
80					80 (82)	110	12	80	100	3.5	
85					85 (86)	110	12	85	105	3.5	
90					90 (92)	115	12	90	110	3.5	
100					100 (102)	125	14	100	120/125	3.5	

Square washers/taper washers

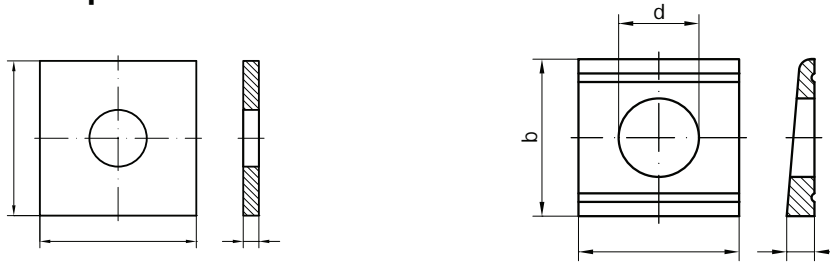

Nominal size = for screws		DIN 436 (Pk C) 0%			DIN 434 (Pk C) 8%			DIN 435 (Pk C) 14%			DIN 6917 (Pk C) 14%			DIN 6918 (Pk C) 14%		
M	Ww	d	a	h	d	a/b	h	d	a/b	h	d	a/b	h	d	a/b	h
8	5/16"				9	22/22	3.8/2	9	22/22	4.6/1.5						
10	3/8"	11	30	3	11	22/22	3.8/2	11	22/22	4.6/1.5	13	26/30	6.2/2	13	26/30	4.9/2.5
12	7/16"	13.5	40	4	13.5	26/30	4.9/2.5	13.5	26/30	6.2/2						
	1/2"	13.5	40	4	13.5	26/30	4.9/2.5	13.5	26/30	6.2/2						
14																
16	5/8"	17.5	50	5	17.5	32/36	5.9/3	17.5	32/36	7.5/2.5	17	32/36	7.5/2.5	17	32/36	5.9/3
18																
20	3/4"	22	60	5	22	40/44	7/3.5	22	40/44	9.2/3	21	40/44	9.2/3	21	40/44	7/3.5
22	7/8"	24	70	6	24	44/50	8/4	24	44/50	10/3	23	44/50	10/3	23	44/50	8/4
24		26	80	6	26	56/56	8.5/4	26	56/56	10.8/3	25	56/56	10.8/3	25*	56/56	8.5/4
	1"	26	80	6	26	56/56	8.5/4	26	56/56	10.8/3						
27		30	90	6	30	56/56	8.5/4	30	56/56	10.8/3	28	56/56	10.8/3	28*	56/56	8.5/4
30	1 1/8"	33	95	6	33	62/62	9/4	33	62/62	11.7/3	31	62/62	11.7/3	31*	62/62	9/4
33	1 1/4"	36	100	6												
36	1 3/8"	39	110	8							37	68/68	12.5/3	37*	68/68	9.4/4
39	1 1/2"	42	125	8							Marking:					
42		45	135	8							DIN	Pitch		Groove qty.		
45	1 3/4"	48	140	8							434	8%		2		
48		52	150	10							435	14%		1		
52	2"	56	160	10							6917	14%		1		
											6918	8% / 5%		2/0 - "Form A"		