

## Dimensions for washers and rings

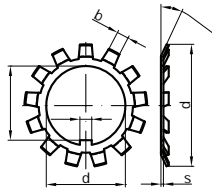

### Retaining/lock washers and rings

DIN	Dimensions	MB 0	MB 1	MB 2	MB 3	MB 4	MB 5	MB 7	MB 7
5406	d <sub>1</sub>	10	12	15	17	20	25	30	35
	d <sub>2</sub>	21	25	28	32	36	42	49	57
	e	3	3	4	4	4	5	5	6
	f	8.5	10.5	13.5	15.5	18.5	23	27.5	32.5
	b <sub>1</sub>	3	3	4	4	4	5	5	5
	s	1	1	1	1	1	1.25	1.25	1.25
	for locknut DIN 981	KM 0	KM 1	KM 2	KM 3	KM 4	KM 5	KM 6	KM 7
	Dimensions	MB 8	MB 9	MB 10	MB 11	MB 12	MB 13	MB 14	MB 15
	d <sub>1</sub>	40	45	50	55	60	65	70	75
	d <sub>2</sub>	62	69	74	81	86.4	92	98	104
	e	6	6	6	8	8	8	8	8
	f	37.5	42.5	47.5	52.5	57.5	62.5	66.5	71.5
	b <sub>1</sub>	6	6	6	7	7	7	8	8
	s	1.25	1.25	1.25	1.5	1.5	1.5	1.5	1.5
	for locknut DIN 981	KM 8	KM 9	KM 10	KM 11	KM 12	KM 13	KM 14	KM 15
Dimensions	MB 16	MB 17	MB 18	MB 19	MB 20	MB 21	MB 22	MB 23	
d <sub>1</sub>	80	85	90	95	100	105	110	115	
d <sub>2</sub>	112	119	126	133	142	145	154	159	
e	10	10	10	10	12	12	12	12	
f	76.5	81.5	86.5	91.5	96.5	100.5	105.5	110.5	
b <sub>1</sub>	8	8	10	10	10	12	12	12	
s	1.75	1.75	1.75	1.75	1.75	1.75	1.75	2	
for locknut DIN 981	KM 16	KM 17	KM 18	KM 19	KM 20	KM 21	KM 22	KM 23	
Dimensions	MB 24	MB 25	MB 26	MB 27	MB 28	MB 29	MB 30		
d <sub>1</sub>	120	125	130	135	140	145	150		
d <sub>2</sub>	164	170	175	185	192	202	205		
e	14	14	14	14	16	16	16		
f	115	120	125	130	135	140	145		
b <sub>1</sub>	12	12	12	14	14	14	14		
s	2	2	2	2	2	2	2		
for locknut DIN 981	KM 24	KM 25	KM 26	KM 27	KM 28	KM 29	KM 30		



DIN	Dimensions	2.2	2.7	3.2	3.7	4.3	5.3	6.4	7.4	8.4	10.5
6797 A * 6798 A **	d <sub>2</sub>	4.5	5.5	6	7	8	10	11	12.5	15	18
	s	0.3	0.4	0.4	0.5	0.5	0.6	0.7	0.8	0.8	0.9
	for thread Ø	2	2.5	3	3.5	4	5	6	7	8	10
6797 I * 6798 I **	Dimensions	13	15	17	19	21	23	25	28	31	
	d <sub>2</sub>	20.5	24	26	30	33	36	38	44	48	
	s	1	1	1.2	1.4	1.4	1.5	1.5	1.6	1.6	
	for thread Ø	12	14	16	18	20	22	24	27	30	

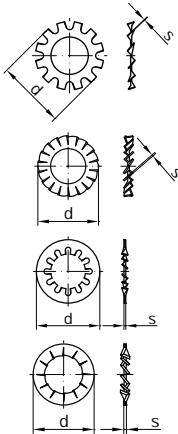

\*) h ≥ 2 x s  
 \*\*) h ≈ 3 x s

DIN	Dimensions	3.2	3.7	4.3	5.3	6.4	8.4	10.5	13
6797 V * 6798 V **	d <sub>2</sub>	6	7	8	9.8	11.8	15.3	19	23
	s	0.2	0.25	0.25	0.3	0.4	0.4	0.5	0.5
	for thread Ø	3	3.5	4	5	6	8	10	12

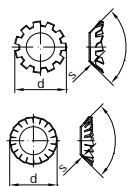

\*) h ≥ 2 x s  
 \*\*) h ≈ 3 x s