



## Dimensions for washers and rings

Note: When inquiring about 5 digit part numbers beginning with 8, please preface the number with R264-. Example: 88111 should be R264-88111.

### Retaining/lock washers and rings

Application examples for  
 R264 - ARTICLE 88494  
 DUBO profile washers:

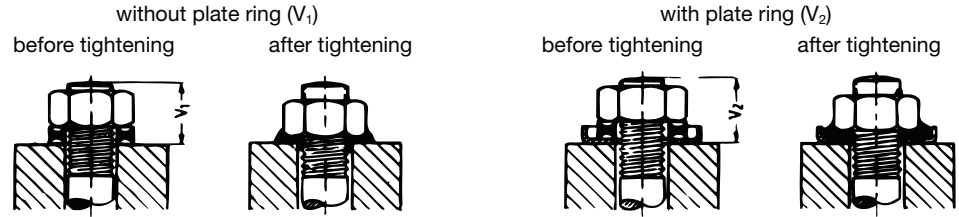

R264 - ARTICLE	Dimensions	299	300	301	303	305	307
88495	for threads	M 4	M 5	M 6	M 8	M 10	M 12
	d <sub>1</sub>	7.7	9.8	10.5	14	17	19
	d <sub>2</sub>	4.1	5.15	6.1	8.1	10.2	12.2
	h <sub>2</sub>	2	3	2.5	3.3	3.8	4.4
	h <sub>1</sub>	0.8	2	1	1.5	1.5	2
	<b>Dimensions</b>	<b>309</b>	<b>311</b>	<b>313</b>	<b>315</b>	<b>317</b>	<b>319</b>
	for threads	M 14	M 16	M 18	M 20	M 22	M 24
	d <sub>1</sub>	23	25	28	31.5	34.5	37.5
	d <sub>2</sub>	14.2	16.2	18.2	20.2	22.2	24.3
	h <sub>2</sub>	5.2	5.6	6.1	6.5	6.8	7
h <sub>1</sub>	2	2	2.3	2.5	2.8	3	

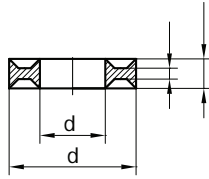

DUBO profile washers for hexagon socket cap screws

Application examples for  
 R264 - ARTICLE 88494  
 DUBO profile washers:

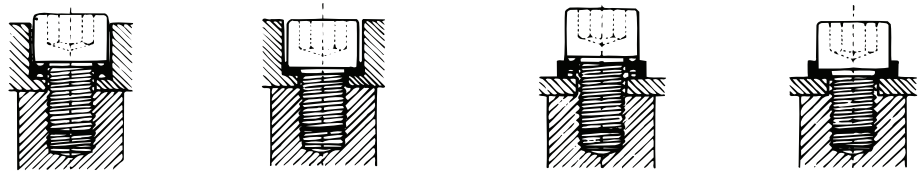

R264 - ARTICLE	Dimensions	404	404	406	408	410	412
88496	D	11.2	11.2	13.2	17.2	21.3	24.5
	d	6.8	6.8	9	12	13.5	15.5
	h	2.5	2.5	3.4	3.8	4.2	4.5
	s	0.65	0.65	0.75	1	1.5	1.5
	for hex. head screws	M 4	M 5	M 6	M 8	M 10	M 12
	for cap screws	5/32"	3/16"	1/4"	5/16"	3/8"	7/16"
	<b>Dimensions</b>	<b>414</b>	<b>416</b>	<b>417</b>	<b>418</b>	<b>419</b>	<b>422</b>
	D	27	31.25	33	37.5	39.5	44
	d	17.5	21	23	26	27	30.5
	h	4.8	5	5	5.5	5.5	6
	s	1.5	1.75	1.75	1.75	1.75	2
	for hex. head screws	M 14	M 16	5/8"	M 18/20	3/4"	M 22/24
	for cap screws	M 16	M 18	M 20	M 22	M 24	7/8"
	for cap screws	5/8"	-	-	3/8"	1/2"	M 14
	<b>Dimensions</b>	<b>427</b>	<b>430</b>	<b>433</b>	<b>436</b>		
	D	50.5	56	61	67		
	d	35	40	45	50		
	h	7	7.5	8	8.3		
s	2	2.5	2.5	2.75			
for hex. head screws	M 27	M 30	M 33	M 36			
for cap screws	1"	1 1/8"	1 1/4"	1 3/8"			
for cap screws	-	-	-	-			

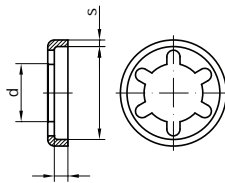

DUBO lock washers