

Accessories and Parts

Miscellaneous accessories such as lock nuts, plugs, adapters, etc. made of nickel plated brass, stainless steel or plastic

GM-FS/Ms	Lock nuts made of plastic or nickel plated brass
V-N-FS/Ms	Dome plugs made of plastic and nickel plated brass
V-NE/Ms	Dome plugs made of plastic or nickel plated brass
V-INOX	Dome plugs made of stainless steel
R-FS/H	Reducers made of plastic or nickel plated brass
R-M-PA	Metric reducers and adapters made of plastic
RS-Ms/RSD-Ms	Metric reducers and adapters made of nickel plated brass
RS-INOX/ RSD-INOX	Reducing bushing made of stainless steel
E-M-PA	Metric enlargers and adapters made of plastic
E-Ms/E-K	Metric enlargers and adapters made of plastic or nickel plated brass
RE-Ms	Adapters made of nickel plated brass
DS/WN	Plastic plugs and threaded nipples
O-Ring	Made of Buna-N or FPM
Thread Seal Ring	Made of Polyethylen or fiber-reinforced plastic
KLE	High performance clamp with flex protection
90° Snap Elbow	Made of nylon 6/6
KF-G	Snap flange made of nylon 6/6
FW-ZN/T	Flange elbow made of plastic or zinc die casting
Cable Ties	Made of nylon 6/6

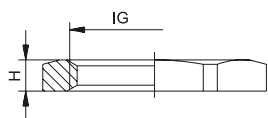



Material
Operating
Temperature
Colors

SB/PA (Nylon)
-20 °C – 40 °C (-4 °F – 104 °F) (SB)
-40 °C – 100 °C (-40 °F – 212 °F) (PA)
grey RAL 7035
black RAL 9005



IG	H mm	Ø mm	Number SB grey	Number PA grey	Number PA black
M 12 x 1,5	5	17		1.262.1200.50	1.262.1201.50
M 16 x 1,5	5	22		1.262.1600.50	1.262.1601.50
M 20 x 1,5	6	27		1.262.2000.50	1.262.2001.50
M 25 x 1,5	7	36		1.262.2500.50	1.262.2501.50
M 32 x 1,5	7	41		1.262.3200.50	1.262.3201.50
M 40 x 1,5	7	50		1.262.4000.50	1.262.4001.50
M 50 x 1,5	8	60		1.262.5000.50	1.262.5001.50
M 63 x 1,5	8	75		1.262.6300.50	1.262.6301.50
PG 7	5	19	1.261.0700.10	1.262.0700.11	1.262.0701.11
PG 9	5	22	1.261.0900.10	1.262.0900.11	1.262.0901.11
PG 11	5	24	1.261.1100.10	1.262.1100.11	1.262.1101.11
PG 13,5	6	27	1.261.1300.10	1.262.1300.11	1.262.1301.11
PG 16	6	30	1.261.1600.10	1.262.1600.11	1.262.1601.11
PG 21	7	36	1.261.2100.10	1.262.2100.11	1.262.2101.11
PG 29	7	46	1.261.2900.10	1.262.2900.11	1.262.2901.11
PG 36	8	60	1.261.3600.10	1.262.3600.11	1.262.3601.11
PG 42	8	65	1.261.4200.10	1.262.4200.11	1.262.4201.11
PG 48	8	70	1.261.4800.10	1.262.4800.11	1.262.4801.11
3/8" NPT	7	24		1.262.3800.70	1.262.3801.70
1/2" NPT	6	27		1.262.1200.70	1.262.1201.70
3/4" NPT	7	32		1.262.3400.70	1.262.3401.70
1" NPT	7	40		1.262.1000.70	1.262.1001.70



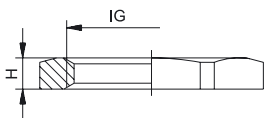

Material Nickel plated brass
INOX (1.4305)

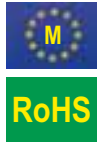

Further sizes upon request

IG	H mm	mm	Number Ms	H mm	mm	Number INOX
M 12 x 1,5	2,8	15	1.161.1200.50	3	17	1.161.1200.58
M 16 x 1,5	2,8	19	1.161.1600.50	3	19	1.161.1600.58
M 20 x 1,5	3,0	23	1.161.2000.50	3	24	1.161.2000.58
M 25 x 1,5	3,5	29	1.161.2500.50	4	27	1.161.2500.58
M 32 x 1,5	4,0	36	1.161.3200.50	5	36	1.161.3200.58
M 40 x 1,5	4,5	45	1.161.4000.50	5	46	1.161.4000.58
M 50 x 1,5	5,5	55	1.161.5000.50	5	55	1.161.5000.58
M 63 x 1,5	6,0	70	1.161.6300.50	6	70	1.161.6300.58
PG 7	2,8	15	1.161.0700.01	2,8	17	1.161.0700.08
PG 9	2,8	18	1.161.0900.01	2,8	22	1.161.0900.08
PG 11	3,0	21	1.161.1100.01	3	22	1.161.1100.08
PG 13,5	3,0	23	1.161.1300.01	3	24	1.161.1300.08
PG16	3,0	26	1.161.1600.01	3	27	1.161.1600.08
PG 21	3,5	32	1.161.2100.01	3,5	32	1.161.2100.08
PG 29	4,0	41	1.161.2900.01	4	41	1.161.2900.08
PG 36	5,0	51	1.161.3600.01	5	50	1.161.3600.08
PG 42	5,0	60	1.161.4200.01			
PG 48	5,5	64	1.161.4800.01			



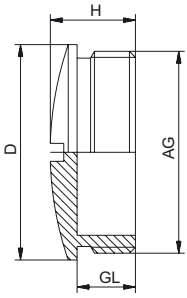

Material SB/PA (Nylon)
 Protection IP 54
 Operating Temperature -20 °C – 70 °C (-4 °F – 158 °F) (SB)
 -40 °C – 100 °C (-40 °F – 212 °F) (PA)
 Colors grey RAL 7035
 black RAL 9005



Other colors available upon request

AG	GL mm	H mm	D mm	Number SB grey	Number PA grey	Number PA black
M 12 x 1,5	6	10	15		1.251.1200.50	1.251.1201.50
M 16 x 1,5	7	11,5	20		1.251.1600.50	1.251.1601.50
M 20 x 1,5	6	9,5	25		1.251.2000.50	1.251.2001.50
M 25 x 1,5	11	15,5	30		1.251.2500.50	1.251.2501.50
M 32 x 1,5	11	16	38		1.251.3200.50	1.251.3201.50
M 40 x 1,5	13	18	46		1.251.4000.50	1.251.4001.50
M 50 x 1,5	13	18,5	56		1.251.5000.50	1.251.5001.50
M 63 x 1,5	15	19	69		1.251.6300.50	1.251.6301.50
PG 7	6	8	15	1.252.0700.10	1.251.0700.11	1.251.0701.11
PG 9	6	9	19	1.252.0900.10	1.251.0900.11	1.251.0901.11
PG 11	6	9	22	1.252.1100.10	1.251.1100.11	1.251.1101.11
PG 13,5	6	9,5	25	1.252.1300.10	1.251.1300.11	1.251.1301.11
PG 16	6	9,5	27	1.252.1600.10	1.251.1600.11	1.251.1601.11
PG 21	8	11	33	1.252.2100.10	1.251.2100.11	1.251.2101.11
PG 29	8	12	44	1.252.2900.10	1.251.2900.11	1.251.2901.11
PG 36	10	15	55	1.252.3600.10	1.251.3600.11	1.251.3601.11
PG 42	10	16	62	1.252.4200.10	1.251.4200.11	1.251.4201.11
PG 48	12	16	69	1.252.4800.10	1.251.4800.11	1.251.4801.11



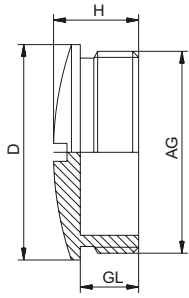

V-N-Ms

Material: Nickel plated brass
Protection: IP 54 (NEMA 2)

V-N-Ms-SD

Material: Nickel plated brass
O-Ring: Buna-N
Protection: IP 68
Operating Temperature: -40 °C – 80 °C (-40 °F – 176 °F)



V-N-Ms

AG	GL mm	H mm	D mm	Number
M 12 x 1,5	5	7,5	14	1.052.1200.50
M 16 x 1,5	5	9,0	18	1.052.1600.50
M 20 x 1,5	6,5	9,5	22	1.052.2000.50
M 25 x 1,5	7	11,0	28	1.052.2500.50
M 32 x 1,5	8	12,0	35	1.052.3200.50
M 40 x 1,5	8,5	13,0	44	1.052.4000.50
M 50 x 1,5	9	15,0	54	1.052.5000.50
M 63 x 1,5	10	16,0	67	1.052.6300.50
PG 7	5	8	14	1.052.0700.01
PG 9	6	9	17	1.052.0900.01
PG 11	6	9	20	1.052.1100.01
PG 13,5	6,5	9,5	22	1.052.1300.01
PG 16	6,5	9,5	24	1.052.1600.01
PG 21	7	11	30	1.052.2100.01
PG 29	8	12	39	1.052.2900.01
PG 36	9	15	50	1.052.3600.01
PG 42	10	16	57	1.052.4200.01
PG 48	10	16	64	1.052.4800.01

V-N-Ms-SD

AG	GL mm	H mm	D mm	Number
M 12 x 1,5	6,5	9,5	14	1.052.1201.50
M 16 x 1,5	6	9	20	1.052.1601.50
M 20 x 1,5	6,5	9,5	24	1.052.2001.50
M 25 x 1,5	7	11	28	1.052.2501.50
M 32 x 1,5	8	12,5	35	1.052.3201.50
M 40 x 1,5	8	12	45	1.052.4001.50
M 50 x 1,5	9	15	55	1.052.5001.50
M 63 x 1,5	10	16	68	1.052.6301.50
PG 7	4,8	8	14	1.052.0701.01
PG 9	5,5	9	17	1.052.0901.01
PG 11	5,5	9	20	1.052.1101.01
PG 13,5	6	9,5	22	1.052.1301.01
PG 16	6	9,5	24	1.052.1601.01
PG 21	6,5	11	30	1.052.2101.01
PG 29	7,5	12	39	1.052.2901.01
PG 36	9	15	50	1.052.3601.01
PG 42	10	16	57	1.052.4201.01
PG 48	10	16	64	1.052.4801.01



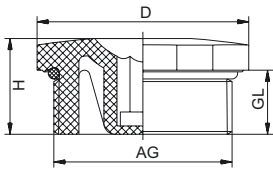

V-NE

Material
Protection
Operating Temperature



PA (Nylon)
IP 54 (NEMA 2)
-20°C – 80°C (-4°F – 176°F)

V-NE-SD

Material
O-Ring
Protection
Operating Temperature
Colors

PA (Nylon)
Buna-N (NE-SD)
IP 68 – 10 bar (NE-SD) / IP 69K
(NEMA 6 – 150 PSIG)
-20°C – 80°C (-4°F – 176°F)
black RAL 9005



AG	GL mm	H mm	D mm	 mm	 mm	Number V-NE	Number V-NE-SD
M 12 x 1,5	8,5	13	16,5	15	6	1.255.1201.50	1.256.1201.50
M 16 x 1,5	8,5	13	20,5	19	8	1.255.1601.50	1.256.1601.50
M 20 x 1,5	9	14,5	25,5	24	8	1.255.2001.50	1.256.2001.50
M 25 x 1,5	10,5	16	30,5	28	8	1.255.2501.50	1.256.2501.50
M 32 x 1,5	11,5	17,5	38	36	8	1.255.3201.50	1.256.3201.50
M 40 x 1,5	11,5	18	48	46	8	1.255.4001.50	1.256.4001.50
M 50 x 1,5	13,5	20	60	55	8	1.255.5001.50	1.256.5001.50
M 63 x 1,5	14,5	21	75	70	8	1.255.6301.50	1.256.6301.50
PG 7	8,5	13	16,5	15	6	1.255.0701.11	1.256.0701.11
PG 9	8,5	13	20,5	19	8	1.255.0901.11	1.256.0901.11
PG 11	9	14,5	25,5	24	8	1.255.1101.11	1.256.1101.11
PG 13,5	9	14,5	25,5	24	8	1.255.1301.11	1.256.1301.11
PG 16	10,5	16	30,5	28	8	1.255.1601.11	1.256.1601.11
PG 21	11,5	17,5	38	36	8	1.255.2101.11	1.256.2101.11
PG 29	11,5	18	48	46	8	1.255.2901.11	1.256.2901.11
PG 36	13,5	20	60	55	8	1.255.3601.11	1.256.3601.11
PG 42	13,5	20	65	60	8	1.255.4201.11	1.256.4201.11
PG 48	14,5	21	75	70	8	1.255.4801.11	1.256.4801.11



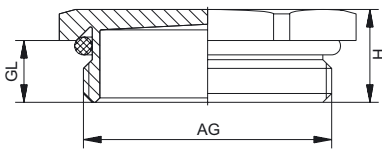

V-NE-Ms

Material Nickel plated brass
Protection IP 54 (NEMA 2)



V-NE-Ms-SD / V-NE-Ms-SD-FPM

Material Nickel plated brass
Protection IP 68 – 10 bar / IP 69K (NE-SD) (NEMA 6 – 150 PSIG)
O-Ring Buna-N (NE-SD) / FPM
Operating Temperature -40 °C – 100 °C (-40 °F – 212 °F)
Temperature -40 °C – 200 °C (-40 °F – 382 °F)

NPT threads available upon request

AG	GL mm	H mm	Ø mm	V-NE-Ms without O-Ring	V-NE-Ms-SD -20 °C – 95 °C (-4 °F – 203 °F)	V-NE-Ms-SD-FPM -20 °C – 180 °C (-4 °F – 356 °F)
M 12 x 1,5	6,5	9,5	14	1.155.1200.50	1.156.1200.50	1.157.1200.50
M 16 x 1,5	6	9	19	1.155.1600.50	1.156.1600.50	1.157.1600.50
M 20 x 1,5	6	9,5	22	1.155.2000.50	1.156.2000.50	1.157.2000.50
M 25 x 1,5	7	10,5	30	1.155.2500.50	1.156.2500.50	1.157.2500.50
M 32 x 1,5	8	12,5	41	1.155.3200.50	1.156.3200.50	1.157.3200.50
M 40 x 1,5	8	13	46	1.155.4000.50	1.156.4000.50	1.157.4000.50
M 50 x 1,5	9	15	55	1.155.5000.50	1.156.5000.50	1.157.5000.50
M 63 x 1,5	10	16,5	70	1.155.6300.50	1.156.6300.50	1.157.6300.50
PG 7	5	8	14	1.155.0700.01	1.156.0700.01	1.157.0700.01
PG 9	6	9	17	1.155.0900.01	1.156.0900.01	1.157.0900.01
PG 11	6	9,5	20	1.155.1100.01	1.156.1100.01	1.157.1100.01
PG 13,5	6,5	10	22	1.155.1300.01	1.156.1300.01	1.157.1300.01
PG 16	6,5	10	24	1.155.1600.01	1.156.1600.01	1.157.1600.01
PG 21	7	10,5	30	1.155.2100.01	1.156.2100.01	1.157.2100.01
PG 29	8	12,5	41	1.155.2900.01	1.156.2900.01	1.157.2900.01
PG 36	8	13	50	1.155.3600.01	1.156.3600.01	1.157.3600.01
PG 42	9	15	58	1.155.4200.01	1.156.4200.01	1.157.4200.01
PG 48	10	16,5	65	1.155.4800.01	1.156.4800.01	1.157.4800.01

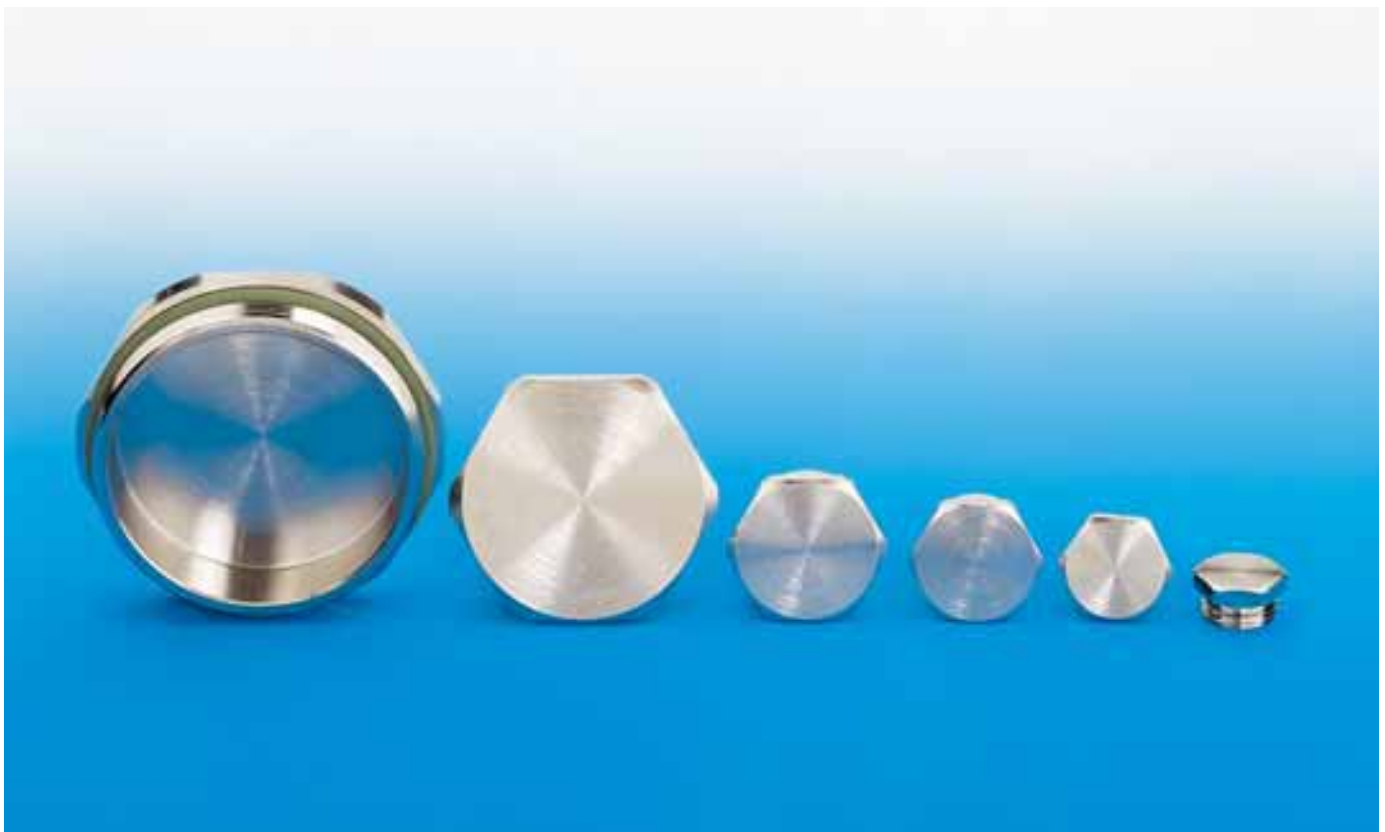

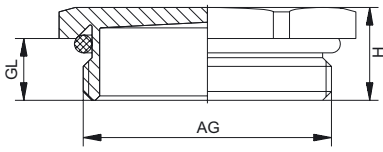

Material
Protection

O-Ring

INOX (1.4305)
IP 68 – 10 bar / IP 69K
(NEMA 6 – 150 PSIG)
Buna-N / FPM / VMQ



AG	GL mm	H mm	Ø mm	Number		
				-20 °C – 95 °C (-4 °F – 203 °F)	-20 °C – 180 °C (-4 °F – 356 °F)	-60 °C – 180 °C (-76 °F – 356 °F)
M 12 x 1,5	6,5	9,5	14	1.152.1200.50	1.153.1200.50	1.154.1200.50
M 16 x 1,5	6	9	19	1.152.1600.50	1.153.1600.50	1.154.1600.50
M 20 x 1,5	6	9,5	22	1.152.2000.50	1.153.2000.50	1.154.2000.50
M 25 x 1,5	7	10,5	30	1.152.2500.50	1.153.2500.50	1.154.2500.50
M 32 x 1,5	8	12,5	41	1.152.3200.50	1.153.3200.50	1.154.3200.50
M 40 x 1,5	8	13	46	1.152.4000.50	1.153.4000.50	1.154.4000.50
PG 7	5	8	14	1.152.0700.01	1.153.0700.01	1.154.0700.01
PG 9	6	9	17	1.152.0900.01	1.153.0900.01	1.154.0900.01
PG 11	6	9,5	20	1.152.1100.01	1.153.1100.01	1.154.1100.01
PG 13,5	6,5	10	22	1.152.1300.01	1.153.1300.01	1.154.1300.01
PG 16	6,5	10	24	1.152.1600.01	1.153.1600.01	1.154.1600.01
PG 21	7	10,5	30	1.152.2100.01	1.153.2100.01	1.154.2100.01
PG 29	8	12,5	41	1.152.2900.01	1.153.2900.01	1.154.2900.01
PG 36	8	13	50	1.152.3600.01	1.153.3600.01	1.154.3600.01

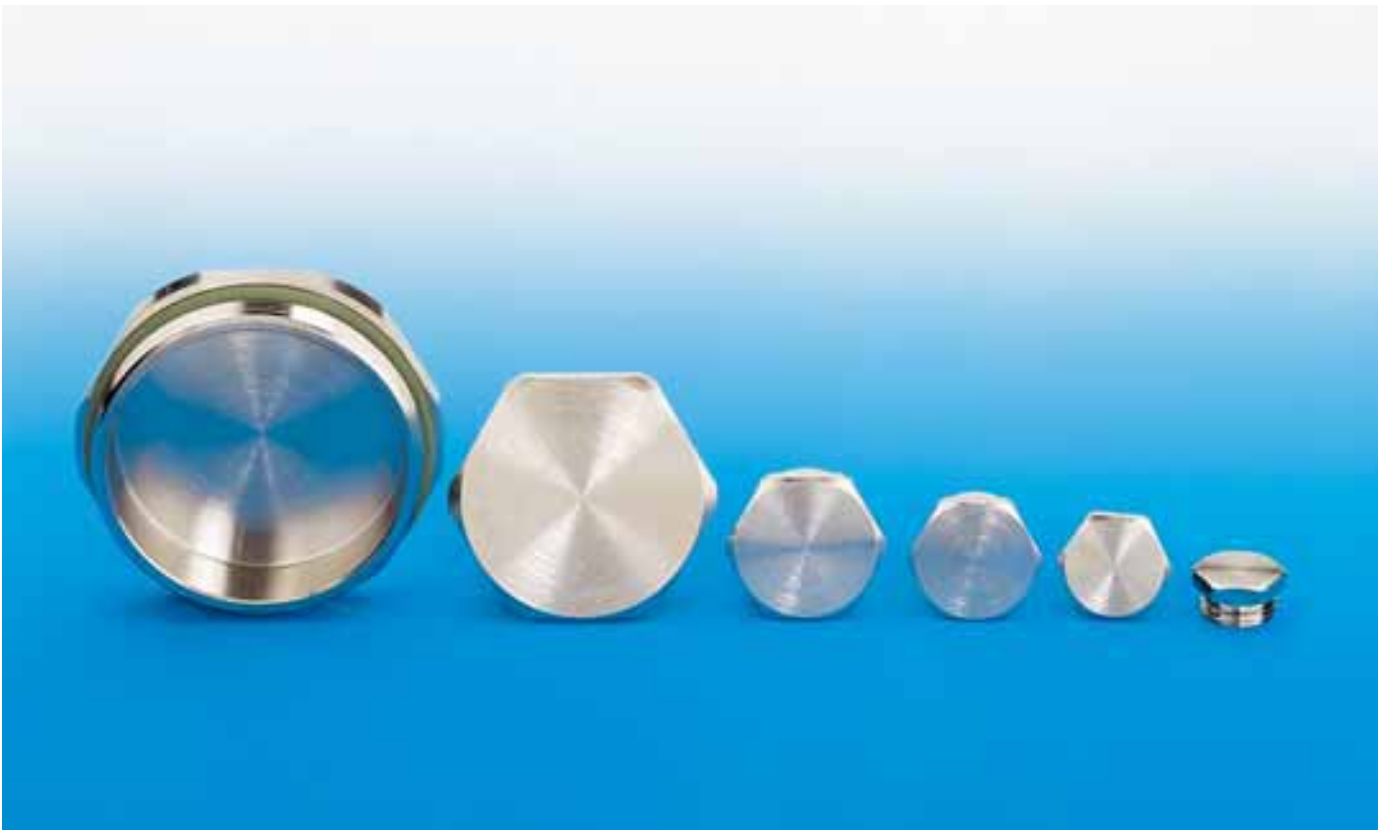

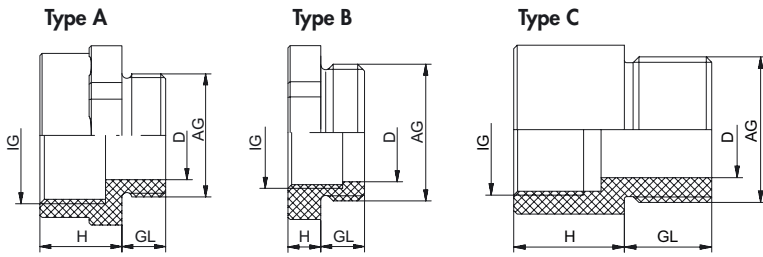

Material
Operating
Temperature
Colors

PA (Nylon)
-20 °C – 80 °C (-4 °F – 176 °F)
black RAL 9005

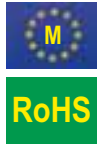

AG	IG	Type	GL mm	H mm	D mm	 mm	Number
M 16 x 1,5	M 12 x 1,5	B	8	6	10	20	1.273.1612.50
M 20 x 1,5	M 16 x 1,5	B	8	6	13,5	25	1.273.2016.50
M 25 x 1,5	M 20 x 1,5	B	8	6	18	29	1.273.2520.50
M 32 x 1,5	M 25 x 1,5	B	10	6	23	36	1.273.3225.50
M 40 x 1,5	M 32 x 1,5	C	15	5	30		1.273.4032.50
M 50 x 1,5	M 40 x 1,5	C	15	5	38		1.273.5040.50
M 63 x 1,5	M 50 x 1,5	C	15	5	48		1.273.6350.50
M 25 x 1,5	PG 13,5	B	8	6	18	29	1.273.2513.50
M 25 x 1,5	PG 16	A	8	14	18	29	1.273.2516.50
M 32 x 1,5	PG 21	A	10	15	25	36	1.273.3221.50
M 40 x 1,5	PG 29	A	10	15	33	45	1.273.4029.50
M 50 x 1,5	PG 36	A	12	17	43	55	1.273.5036.50
M 63 x 1,5	PG 42	C	15	5	52		1.273.6342.50
PG 9	M 12 x 1,5	C	15	19	8,5		1.273.0912.11
PG 11	M 16 x 1,5	C	15	19	11,5		1.273.1116.11
PG 13,5	M 16 x 1,5	B	8	6	14	25	1.273.1316.11
PG 16	M 20 x 1,5	A	8	13	16	27	1.273.1620.11
PG 21	M 25 x 1,5	C	15	19	20,5		1.273.2125.11
PG 29	M 32 x 1,5	C	15	19	28		1.273.2932.11
PG 36	M 40 x 1,5	C	15	5	38		1.273.3640.11
PG 42	M 40 x 1,5	C	15	5	38		1.273.4240.11
PG 48	M 50 x 1,5	C	15	5	38		1.273.4850.11



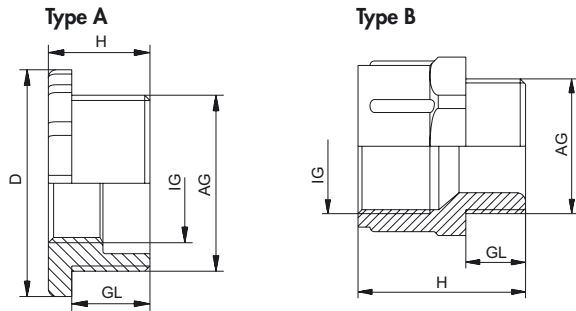

Material
Operating
Temperature
Colors

SB
PA (Nylon)
-20°C – 70°C (-4°F – 158°F) (SB)
-40°C – 80°C (-40°F – 176°F) (PA)
grey RAL 7035



AG	IG	GL mm	H mm	D mm	mm	Type	Number SB	Number PA
M 16 x 1,5	M 12 x 1,5	9	27	22	20	B		1.272.1612.50
M 20 x 1,5	M 16 x 1,5	9	27	27	24	B		1.272.2016.50
M 25 x 1,5	M 20 x 1,5	10	17	32	29	A		1.272.2520.50
M 32 x 1,5	M 25 x 1,5	12	19	40	36	A		1.272.3225.50
M 40 x 1,5	M 32 x 1,5	12	19	51	46	A		1.272.4032.50
M 50 x 1,5	M 40 x 1,5	14	21	61	55	A		1.272.5040.50
M 63 x 1,5	M 50 x 1,5	15	22	75	68	A		1.272.6350.50
PG 13,5	PG 9	8	12	27		A	1.271.1309.10	1.272.1309.11
PG 16	PG 9	10	13	29		A	1.271.1609.10	1.272.1609.11
PG 16	PG 11	10	13	29		A	1.271.1611.10	1.272.1611.11
PG 21	PG 13,5	11	13,5	36		A	1.271.2113.10	1.272.2113.11
PG 21	PG 16	11	13,5	36		A	1.271.2116.10	1.272.2116.11
PG 29	PG 21	11	13,5	46		A	1.271.2921.10	1.272.2921.11
PG 36	PG 29	11	15	58		A	1.271.3629.10	1.272.3629.11
Reducing intermediate connector								
PG 9	PG 7	8	14	19		B	1.235.0907.10	1.236.0907.11
PG 11	PG 9	8	18	22,5		B	1.235.1109.10	1.236.1109.11
PG 13,5	PG 11	9	21	25,5		B	1.235.1311.10	1.236.1311.11
PG 16	PG 13,5	10	25	28,5		B	1.235.1613.10	1.236.1613.11



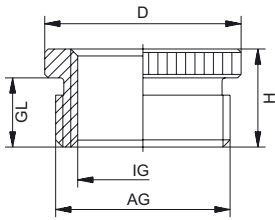

Material

Nickel plated brass

Metric threads with O-Ring thread seal available



AG	IG	GL mm	H mm	D mm	Number
M 16 x 1,5	M 12 x 1,5	6,0	8,5	18	1.076.1612.50
M 20 x 1,5	M 12 x 1,5	6,5	9,0	24	1.076.2012.50
M 20 x 1,5	M 16 x 1,5	6,5	9,0	24	1.076.2016.50
M 25 x 1,5	M 16 x 1,5	7,0	10,0	30	1.076.2516.50
M 25 x 1,5	M 20 x 1,5	7,0	10,0	30	1.076.2520.50
M 32 x 1,5	M 20 x 1,5	8,0	11,5	39	1.076.3220.50
M 32 x 1,5	M 25 x 1,5	8,0	11,5	39	1.076.3225.50
M 40 x 1,5	M 25 x 1,5	8,0	11,5	43	1.076.4025.50
M 40 x 1,5	M 32 x 1,5	9,0	12,5	43	1.076.4032.50
M 50 x 1,5	M 32 x 1,5	10,0	14,0	57	1.076.5032.50
M 50 x 1,5	M 40 x 1,5	10,0	14,0	57	1.076.5040.50
M 63 x 1,5	M 40 x 1,5	10,0	14,0	64	1.076.6340.50
M 63 x 1,5	M 50 x 1,5	10,0	14,0	64	1.076.6350.50

AG	IG	GL mm	H mm	D mm	Number
PG 9	PG 7	6	8,5	17	1.071.0907.01
PG 11	PG 7	6	8,5	20	1.071.1107.01
PG 11	PG 9	6	8,5	20	1.071.1109.01
PG 13,5	PG 9	6,5	9	22	1.071.1309.01
PG 13,5	PG 11	6,5	9	22	1.071.1311.01
PG 16	PG 9	6,5	9,5	24	1.071.1609.01
PG 16	PG 11	6,5	9,5	24	1.071.1611.01
PG 16	PG 13,5	6,5	9,5	24	1.071.1613.01
PG 21	PG 11	7	10	30	1.071.2111.01
PG 21	PG 13,5	7	10	30	1.071.2113.01
PG 21	PG 16	7	10	30	1.071.2116.01
PG 29	PG 16	8	11,5	39	1.071.2916.01
PG 29	PG 21	8	11,5	39	1.071.2921.01
PG 36	PG 21	9	12,5	50	1.071.3621.01
PG 36	PG 29	9	12,5	50	1.071.3629.01
PG 42	PG 29	10	14	57	1.071.4229.01
PG 42	PG 36	10	14	57	1.071.4236.01
PG 48	PG 36	10	14	64	1.071.4836.01
PG 48	PG 42	10	14	64	1.071.4842.01



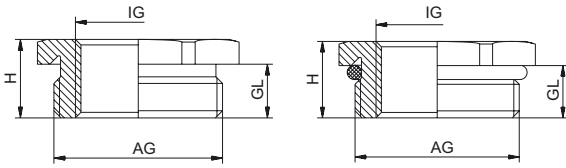



Reducer RS-Ms
Material

Nickel plated brass

Reducer RSD-Ms
Material
O-Ring

Nickel plated brass
Buna-N



AG	IG	GL mm	H mm	 mm	Number RSD-Ms	AG	IG	GL mm	H mm	 mm	Number RS-Ms	Number RSD-Ms
M 16 x 1,5	M 12 x 1,5	5	8	17	1.077.1612.50	PG 9	PG 7	6	8,8	17	1.074.0907.01	1.077.0907.01
M 20 x 1,5	M 12 x 1,5	6	9	22	1.077.2012.50	PG 11	PG 7	6	9	20	1.074.1107.01	1.077.1107.01
M 20 x 1,5	M 16 x 1,5	6	9	22	1.077.2016.50	PG 11	PG 9	6	9	20	1.074.1109.01	1.077.1109.01
M 25 x 1,5	M 16 x 1,5	7	10	27	1.077.2516.50	PG 13,5	PG 9	6,5	9,5	22	1.074.1309.01	1.077.1309.01
M 25 x 1,5	M 20 x 1,5	7	10	27	1.077.2520.50	PG 13,5	PG 11	6,5	9,5	22	1.074.1311.01	1.077.1311.01
M 32 x 1,5	M 16 x 1,5	8	11	34	1.077.3216.50	PG 16	PG 9	6,5	9,5	24	1.074.1609.01	1.077.1609.01
M 32 x 1,5	M 20 x 1,5	8	11	34	1.077.3220.50	PG 16	PG 11	6,5	9,5	24	1.074.1611.01	1.077.1611.01
M 32 x 1,5	M 25 x 1,5	8	11	34	1.077.3225.50	PG 16	PG 13,5	6,5	9,5	24	1.074.1613.01	1.077.1613.01
M 40 x 1,5	M 20 x 1,5	8	12	43	1.077.4020.50	PG 21	PG 11	7	10,3	30	1.074.2111.01	1.077.2111.01
M 40 x 1,5	M 25 x 1,5	8	12	43	1.077.4025.50	PG 21	PG 13,5	7	10,3	30	1.074.2113.01	1.077.2113.01
M 40 x 1,5	M 32 x 1,5	8	12	43	1.077.4032.50	PG 21	PG 16	7	10,3	30	1.074.2116.01	1.077.2116.01
M 50 x 1,5	M 25 x 1,5	9	13	55	1.077.5025.50	PG 29	PG 16	8	11,5	40	1.074.2916.01	1.077.2916.01
M 50 x 1,5	M 32 x 1,5	9	13	55	1.077.5032.50	PG 29	PG 21	8	11,5	40	1.074.2921.01	1.077.2921.01
M 50 x 1,5	M 40 x 1,5	9	13	55	1.077.5040.50	PG 36	PG 21	9	12,5	50	1.074.3621.01	1.077.3621.01
M 63 x 1,5	M 32 x 1,5	10	14	65	1.077.6332.50	PG 36	PG 29	9	12,5	50	1.074.3629.01	1.077.3629.01
M 63 x 1,5	M 40 x 1,5	10	14	65	1.077.6340.50	PG 42	PG 29	10	13,5	57	1.074.4229.01	1.077.4229.01
M 63 x 1,5	M 50 x 1,5	10	14	65	1.077.6350.50	PG 42	PG 36	10	13,5	57	1.074.4236.01	1.077.4236.01
						PG 48	PG 36	10	13,5	64	1.074.4836.01	1.077.4836.01
						PG 48	PG 42	10	13,5	64	1.074.4842.01	1.077.4842.01



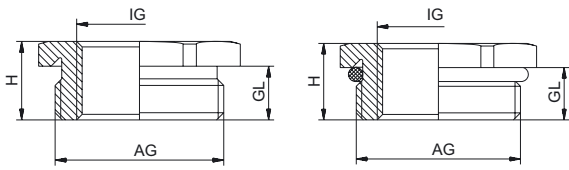

RS-INOX
Material

INOX (1.4305)

RSD-INOX
Material
O-Ring

INOX (1.4305)
Buna-N

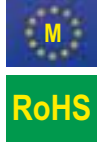

O-Ring made of FPM / VMQ on request

316 Stainless Steel available upon request

AG	IG	GL mm	H mm	 mm	Number RS-INOX	Number RSD-INOX
M 16 x 1,5	M 12 x 1,5	5	9	17	1.094.1612.50	1.097.1612.50
M 20 x 1,5	M 12 x 1,5	6	9,5	22	1.094.2012.50	1.097.2012.50
M 20 x 1,5	M 16 x 1,5	6	9,5	22	1.094.2016.50	1.097.2016.50
M 25 x 1,5	M 16 x 1,5	7	10,5	27	1.094.2516.50	1.097.2516.50
M 25 x 1,5	M 20 x 1,5	7	10,5	27	1.094.2520.50	1.097.2520.50
M 32 x 1,5	M 16 x 1,5	8	12,5	34	1.094.3216.50	1.097.3216.50
M 32 x 1,5	M 20 x 1,5	8	12,5	34	1.094.3220.50	1.097.3220.50
M 32 x 1,5	M 25 x 1,5	8	12,5	34	1.094.3225.50	1.097.3225.50
M 40 x 1,5	M 20 x 1,5	8	13	43	1.094.4020.50	1.097.4020.50
M 40 x 1,5	M 25 x 1,5	8	13	43	1.094.4025.50	1.097.4025.50
M 40 x 1,5	M 32 x 1,5	8	13	43	1.094.4032.50	1.097.4032.50
M 50 x 1,5	M 25 x 1,5	9	15	55	1.094.5025.50	1.097.5025.50
M 50 x 1,5	M 32 x 1,5	9	15	55	1.094.5032.50	1.097.5032.50
M 50 x 1,5	M 40 x 1,5	9	15	55	1.094.5040.50	1.097.5040.50
M 63 x 1,5	M 32 x 1,5	10	16,5	65	1.094.6332.50	1.097.6332.50
M 63 x 1,5	M 40 x 1,5	10	16,5	65	1.094.6340.50	1.097.6340.50
M 63 x 1,5	M 50 x 1,5	10	16,5	65	1.094.6350.50	1.097.6350.50

AG	IG	GL mm	H mm	 mm	Number RS-INOX	Number RSD-INOX
PG 9	PG 7	6	8,8	17	1.094.0907.01	1.097.0907.01
PG 11	PG 7	6	9	22	1.094.1107.01	1.097.1107.01
PG 11	PG 9	6	9	22	1.094.1109.01	1.097.1109.01
PG 13,5	PG 9	6,5	9,5	22	1.094.1309.01	1.097.1309.01
PG 13,5	PG 11	6,5	9,5	22	1.094.1311.01	1.097.1311.01
PG 16	PG 9	6,5	9,5	24	1.094.1609.01	1.097.1609.01
PG 16	PG 11	6,5	9,5	24	1.094.1611.01	1.097.1611.01
PG 16	PG 13,5	6,5	9,5	24	1.094.1613.01	1.097.1613.01
PG 21	PG 11	7	10,3	30	1.094.2111.01	1.097.2111.01
PG 21	PG 13,5	7	10,3	30	1.094.2113.01	1.097.2113.01
PG 21	PG 16	7	10,3	30	1.094.2116.01	1.097.2116.01
PG 29	PG 16	8	11,5	40	1.094.2916.01	1.097.2916.01
PG 29	PG 21	8	11,5	40	1.094.2921.01	1.097.2921.01
PG 36	PG 21	9	12,5	50	1.094.3621.01	1.097.3621.01
PG 36	PG 29	9	12,5	50	1.094.3629.01	1.097.3629.01
PG 42	PG 29	10	13,5	57	1.094.4229.01	1.097.4229.01
PG 42	PG 36	10	13,5	57	1.094.4236.01	1.097.4236.01
PG 48	PG 36	10	13,5	64	1.094.4836.01	1.097.4836.01
PG 48	PG 42	10	13,5	64	1.094.4842.01	1.097.4842.01



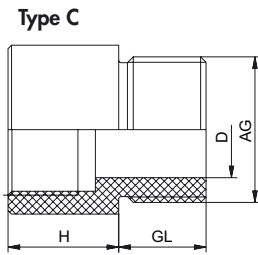
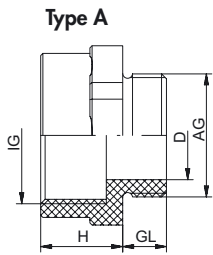

Material
Operating
Temperature
Colors

PA (Nylon)
-20 °C – 80 °C (-4 °F – 176 °F)
black RAL 9005



AG	IG	Type	GL mm	H mm	D mm	 mm	Number
M 12 x 1,5	M 16 x 1,5	A	8	12	6,5	21	1.239.1216.50
M 16 x 1,5	M 20 x 1,5	A	8	13	9	25	1.239.1620.50
M 20 x 1,5	M 25 x 1,5	A	8	15	14	30	1.239.2025.50
M 25 x 1,5	M 32 x 1,5	C	15	15	16,5		1.239.2532.50
M 32 x 1,5	M 40 x 1,5	C	15	19,5	23		1.239.3240.50
M 40 x 1,5	M 50 x 1,5	C	15	19,5	30		1.239.4050.50
M 50 x 1,5	M 63 x 1,5	C	15	20	39		1.239.5063.50
M 12 x 1,5	PG 7	A	8	12	6,5	17	1.239.1207.50
M 16 x 1,5	PG 9	C	1	19	8,5		1.239.1609.50
M 20 x 1,5	PG 13,5	A	8	13	14	25	1.239.2013.50
M 63 x 1,5	PG 48	C	15	20	51		1.239.6348.50
PG 7	M 12 x 1,5	C	15	19	6		1.239.0712.11
PG 9	M 16 x 1,5	A	8	12	9	21	1.239.0916.11
PG 11	M 20 x 1,5	C	15	19	11,5		1.239.1120.11
PG 13,5	M 20 x 1,5	A	8	13	14	25	1.239.1320.11
PG 16	M 25 x 1,5	A	8	15	16	30	1.239.1625.11
PG 21	M 32 x 1,5	A	8	15	21	37	1.239.2132.11
PG 29	M 40 x 1,5	A	10	17	30	45	1.239.2940.11
PG 36	M 50 x 1,5	C	15	19,5	37		1.239.3650.11
PG 42	M 50 x 1,5	C	15	19,5	43		1.239.4250.11
PG 48	M 63 x 1,5	C	15	20	48		1.239.4863.11



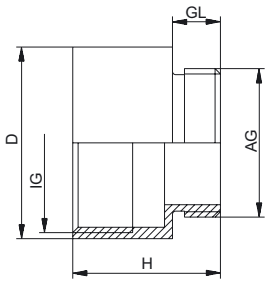

Enlarger E-Ms

Material

Nickel plated brass

Enlarger K-Fs

Material

PA (Nylon)

Colors

black RAL 7035

* Type K-Fs



AG	IG	GL mm	H mm	D mm	Number
M 12 x 1,5	M 16 x 1,5	5	15	18	1.033.1216.50
M 16 x 1,5	M 20 x 1,5	6	17,5	22	1.033.1620.50
M 20 x 1,5	M 25 x 1,5	6,5	19	27	1.033.2025.50
M 25 x 1,5	M 32 x 1,5	6,5	21	34	1.033.2532.50
M 32 x 1,5	M 40 x 1,5	7	23	42	1.033.3240.50
M 40 x 1,5	M 50 x 1,5	9	31	53	1.033.4050.50
M 50 x 1,5	M 63 x 1,5	9	31	66	1.033.5063.50
PG 7	PG 9	5	15	17	1.033.0709.01
PG 9	PG 11	6	16,5	20	1.033.0911.01
PG 9	PG 13,5	6	17,5	22	1.033.0913.01
PG 11	PG 13,5	6	17,5	22	1.033.1113.01
PG 11	PG 16	6	18,5	24	1.033.1116.01
PG 11	PG 21	6	20,5	30	1.033.1121.01
PG 13,5	PG 16	6,5	19	24	1.033.1316.01
PG 13,5	PG 21	6,5	21	30	1.033.1321.01
PG 16	PG 21	6,5	21	30	1.033.1621.01
PG 16	PG 29	6,5	22,5	39	1.033.1629.01
PG 21	PG 29	7	23	39	1.033.2129.01
PG 29	PG 36	8	27,5	50	1.033.2936.01
PG 36	PG 42	9	31	57	1.033.3642.01
PG 42	PG 48	10	33	64	1.033.4248.01
PG 11 *	PG 13,5	8	15	24	1.233.1113.11
PG 13,5 *	PG 16	9	16	27	1.233.1316.11
PG 16 *	PG 21	10	19	33	1.233.1621.11
PG 21 *	PG 29	11	21	42	1.233.2129.11



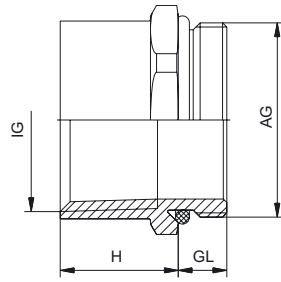
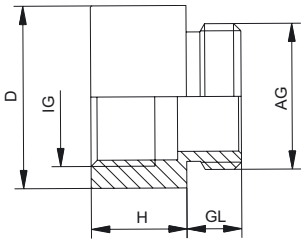

Material

Nickel plated brass



RoHS

AG	IG	GL mm	H mm	D mm	 mm	Number
M 16 x 1,5	PG 9	6	10,5	20		1.039.1609.01
M 20 x 1,5	PG 11	6,5	12,5	22		1.039.2011.01
M 20 x 1,5	PG 13,5	6,5	12,5	22		1.039.2013.01
M 20 x 1,5	PG 16	6,5	12,5	24		1.039.2016.01
M 25 x 1,5	PG 16	6,5	12,5	28		1.039.2516.01
M 25 x 1,5	PG 21	6,5	14,5	30		1.039.2521.01
M 32 x 1,5	PG 29	7	16	39		1.039.3229.01
M 16 x 1,5	1/2" NPT	6	17		24	1.171.1612.50
M 20 x 1,5	1/2" NPT	6	17		24	1.171.2012.50
M 25 x 1,5	1/2" NPT	7	8		30	1.171.2512.50
M 25 x 1,5	3/4" NPT	7	19		30	1.171.2534.50
M 32 x 1,5	1" NPT	8	25		40	1.171.3210.50
M 32 x 1,5	1 1/4" NPT	8	25		46	1.171.3254.50
PG 9	M 16 x 1,5	6	10,5	20		1.039.0916.01
PG 11	M 20 x 1,5	6,5	12,5	22		1.039.1120.01
PG 13,5	M 20 x 1,5	6,5	12,5	22		1.039.1320.01
PG 16	M 25 x 1,5	6,5	14,5	27		1.039.1625.01
PG 11	1/2" NPT	6	16,7		24	1.171.1112.01
PG 13,5	1/2" NPT	6,5	17		24	1.171.1312.01
PG 16	1/2" NPT	6,5	16,5		24	1.171.1612.01
PG 21	1/2" NPT	7	8		30	1.171.2112.01
PG 21	3/4" NPT	7	17		30	1.171.2134.01
PG 29	1" NPT	8	12		40	1.171.2910.01



Seal Plug DS

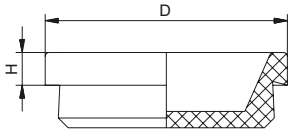

Threaded Seal Hex Plug WN

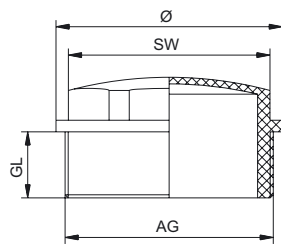

Seal Plug DS

Material: Elastomer
 Protection: IP 54
 Operating Temperature: -20 °C – 80 °C (-4 °F – 176 °F)



Threaded Seal Hex Plug WN

Material: PE (Nylon)
 Protection: IP 54
 Operating Temperature: -20 °C – 80 °C (-4 °F – 176 °F)

Seal Plug DS

Ø mm	D mm	H mm	Number
12	17	5	1.250.1201.50
16	20	5	1.250.1601.50
20	25	5	1.250.2001.50
25	30	5	1.250.2501.50
32	37	5	1.250.3201.50
40	45	5	1.250.4001.50
50	56	5	1.250.5001.50
63	70	5	1.250.6301.50

Threaded Seal Hex Plug WN

AG	GL mm	Ø mm	mm	Number
16	9	19,8	15	1.282.1600.50
20	12	24	19	1.282.2000.50
25	12	29,5	24	1.282.2500.50
32	14	37,5	30	1.282.3200.50
40	14	65,8	37	1.282.4000.50
50	18	55,8	46	1.282.5000.50
63	20	68,8	56	1.282.6300.50



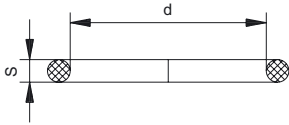

O-Ring NBR

Material: Buna-N
 Operating Temperature: -30 °C – 120 °C (-22 °F – 248 °F)

O-Ring FPM

Material: FPM
 Operating Temperature: -40 °C – 200 °C (-104 °F – 392 °F)



O-Ring for HSK-K

Fits the Following Sizes	d mm	s mm	Number Buna-N	Number FPM
M 12 x 1,5	10	1,5	1.321.1200.57	1.321.1200.58
M 16 x 1,5	12	1,5	1.321.1600.57	1.321.1600.58
M 20 x 1,5	17	1,8	1.321.2000.57	1.321.2000.58
M 25 x 1,5	22	2	1.321.2500.57	1.321.2500.58
M 32 x 1,5	29	2	1.321.3200.57	1.321.3200.58
M 40 x 1,5	35	2	1.321.4000.57	1.321.4000.58
M 50 x 1,5	43	2	1.321.5000.57	1.321.5000.58
M 63 x 1,5	55	2	1.321.6300.57	1.321.6300.58
PG 7	10	1,5	1.321.0700.17	1.321.0700.21
PG 9	12	1,5	1.321.0900.17	1.321.0900.21
PG 11	16	1,5	1.321.1100.17	1.321.1100.21
PG 13,5	17	1,8	1.321.1300.17	1.321.1300.21
PG 16	18	1,5	1.321.1600.17	1.321.1600.21
PG 21	26	2	1.321.2100.17	1.321.2100.21
PG 29	33	2	1.321.2900.17	1.321.2900.21
PG 36	43	2	1.321.3600.17	1.321.3600.21
PG 42	50	2	1.321.4200.17	1.321.4200.21
PG 48	55	2	1.321.4800.17	1.321.4800.21
3/8" NPT	13	2	1.321.3800.77	1.321.3800.78
1/2" NPT	19	1,8	1.321.1200.77	1.321.1200.78
3/4" NPT	22	2	1.321.3400.77	1.321.3400.78
1" NPT	29	2	1.321.1000.77	1.321.1000.78
1 1/4" NPT	38	2,5	1.321.5400.77	1.321.5400.78
1 1/2" NPT	45	2,5	1.321.6400.77	1.321.6400.78

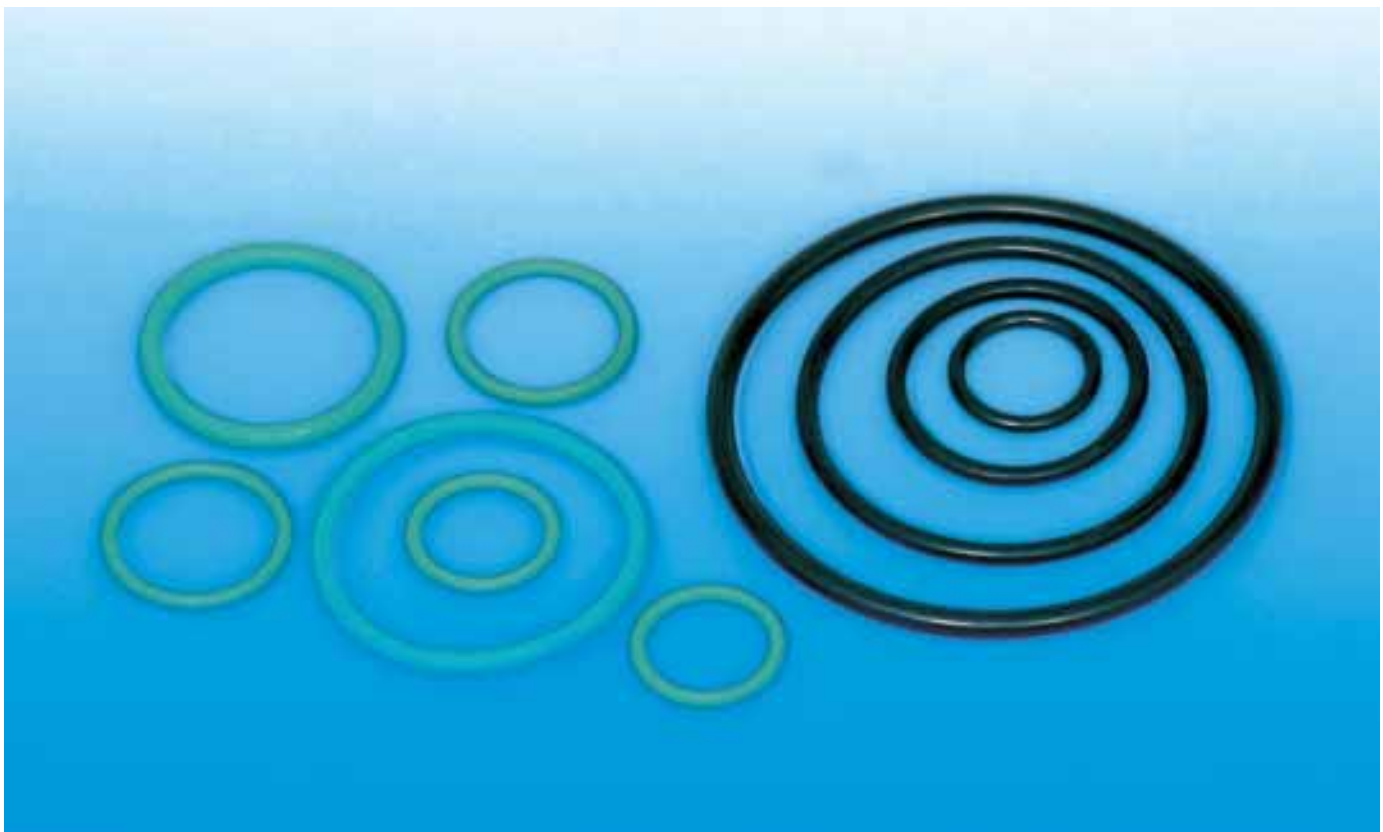

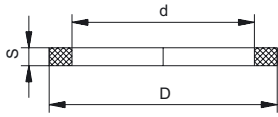

Thread Seal Ring PE

Material Polyethylen
 Operating Temperature -30 °C – 70 °C (-22 °F – 158 °F)



Thread Seal Ring HD

Material Fiber-reinforced plastic
 Operating Temperature -55 °C – 300 °C (-67 °F – 572 °F)

Size	d mm	D mm	S mm	Number PE	Number HD
M 12 x 1,5	12	16	2	1.325.1200.59	1.325.1200.50
M 16 x 1,5	16	20	2	1.325.1600.59	1.325.1600.50
M 20 x 1,5	20	25	2	1.325.2000.59	1.325.2000.50
M 25 x 1,5	25	31	2	1.325.2500.59	1.325.2500.50
M 32 x 1,5	32	38	2	1.325.3200.59	1.325.3200.50
M 40 x 1,5	40	48	2	1.325.4000.59	1.325.4000.50
M 50 x 1,5	50	58	2	1.325.5000.59	1.325.5000.50
M 63 x 1,5	63	72	2	1.325.6300.59	1.325.6300.50
PG 7	12,5	16,5	1,5	1.325.0700.19	1.325.0700.20
PG 9	15,2	19	1,5	1.325.0900.19	1.325.0900.20
PG 11	18,6	22,5	1,5	1.325.1100.19	1.325.1100.20
PG 13,5	20,4	25	1,5	1.325.1300.19	1.325.1300.20
PG 16	22,5	27	1,5	1.325.1600.19	1.325.1600.20
PG 21	28,3	33,5	1,5	1.325.2100.19	1.325.2100.20
PG 29	37	43,5	2	1.325.2900.19	1.325.2900.20
PG 36	47	55	2	1.325.3600.19	1.325.3600.20
PG 42	54	63	2	1.325.4200.19	1.325.4200.20
PG 48	59,3	69	2	1.325.4800.19	1.325.4800.20

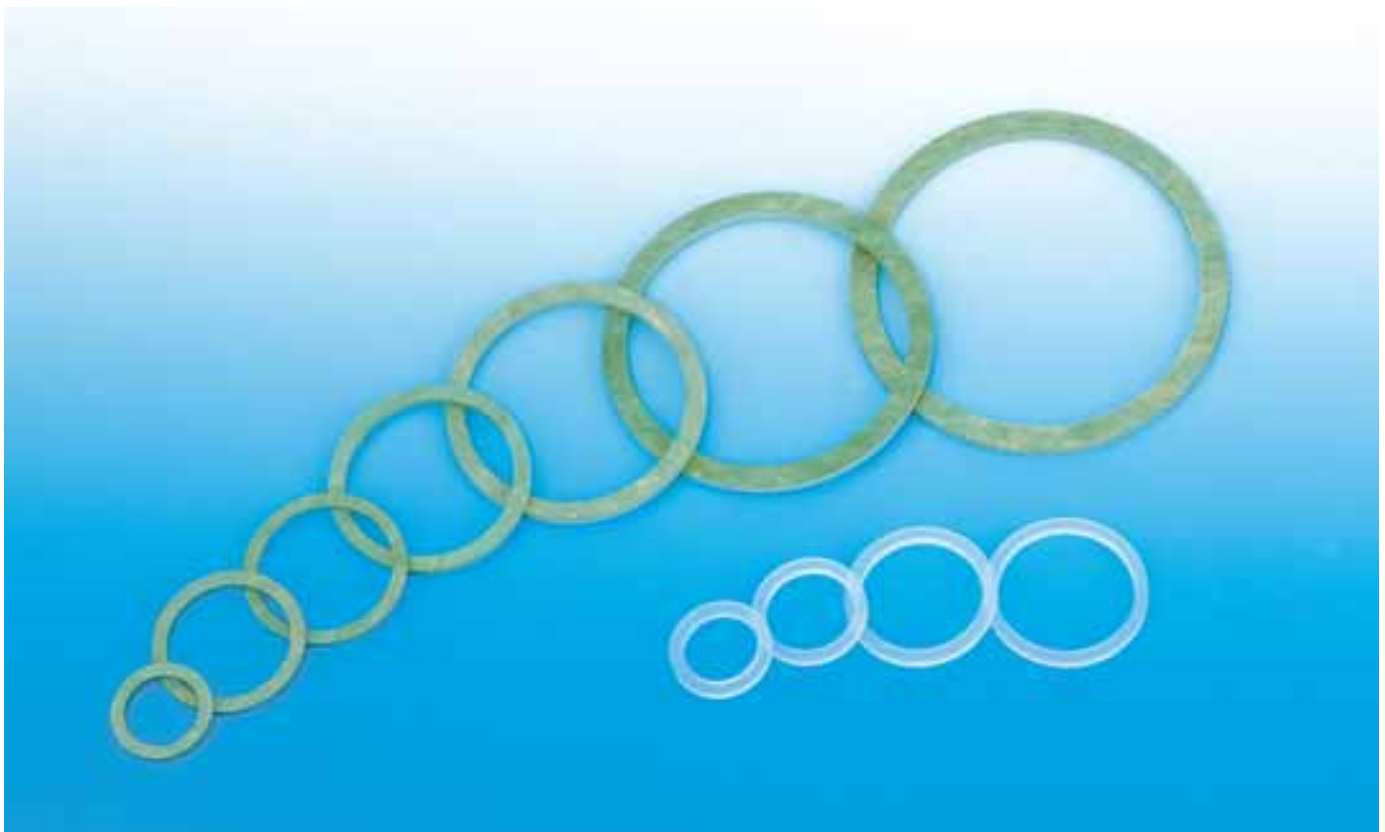

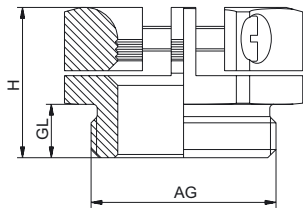



Material

Nickel plated brass

RoHS

AG	GL mm	H mm	 mm	 mm	Number
M12x1,5	5,5	15,0	16	5 - 7,5	1.143.1200.50
M16x1,5	6,0	16,0	19	7 - 10	1.143.1600.50
M20x1,5	6,5	18,0	24	10 - 14	1.143.2000.50
M25x1,5	8,0	21,0	34	12 - 21,5	1.143.2500.50
M32x1,5	8,0	22,0	42	16 - 27	1.143.3200.50
M40x1,5	9,5	25,5	52	22 - 33	1.143.4000.50
M50x1,5	9,5	25,5	52	25 - 38,5	1.143.5000.50
PG 7	5,5	14,8	16	5,5 - 8	1.143.0700.01
PG 9	6	16,6	19	6,5 - 10	1.143.0900.01
PG 11	6	17,3	22	7,5 - 12	1.143.1100.01
PG 13,5	6,5	17,8	24	8,5 - 14	1.143.1300.01
PG 16	6,5	18,3	26	9,5 - 16	1.143.1600.01
PG 21	7,5	20,8	33	12 - 21	1.143.2100.01
PG 29	8	21,8	42	19 - 30	1.143.2900.01
PG 36	9,5	25,3	52	25 - 37	1.143.3600.01
PG 42	10	26,3	59	31 - 43	1.143.4200.01
PG 48	11	27,3	64	35 - 48	1.143.4800.01



90° Snap Elbow

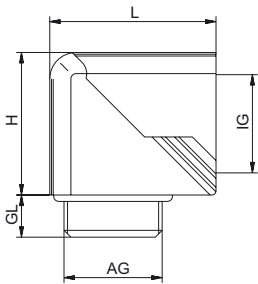

Metr./PG/NPT



Material
O-Ring
Protection
Operating
Temperature
Colors

PA (Nylon)
Buna-N
IP 68
-20 °C – 80 °C (-4 °F – 176 °F)
grey RAL 7035
black RAL 9005



AG	IG	GL mm	H mm	L mm	 mm	 mm	Number grey	Number black
M 16x1,5	M16x1,5	8	23	28,5	5	19	1.316.1600.50	1.316.1601.50
M 20x1,5	M 20x1,5	9	30,5	35	7	24	1.316.2000.50	1.316.2001.50
M 25x1,5	M 25x1,5	11	40	49	10	33	1.316.2500.50	1.316.2501.50
Pg 9	M 16x1,5	8	23	28,5	5	19	1.316.0900.11	1.316.0901.11
Pg 13,5	M 20x1,5	9	30,5	35	7	24	1.316.1300.11	1.316.1301.11
Pg 21	M 25x1,5	11	40	49	10	33	1.316.2100.11	1.316.2101.11
M 16 x 1,5	PG 9	8	23	28,5	5	19	1.315.1600.50	1.315.1601.50
M 20 x 1,5	PG 13,5	9	30,5	35	7	24	1.315.2000.50	1.315.2001.50
M 25 x 1,5	PG 21	11	40	49	10	33	1.315.2500.50	1.315.2501.50
M 32 x 1,5	PG 29	11	51,5	60	14	42	1.315.3200.50	1.315.3201.50
PG 9	PG 9	8	23	28,5	5	19	1.315.0900.11	1.315.0901.11
PG 11	PG 11	8	27	31,5	6	22	1.315.1100.11	1.315.1101.11
PG 13,5	PG 13,5	9	30,5	35	7	24	1.315.1300.11	1.315.1301.11
PG 16	PG 16	10	32,5	37,5	8	27	1.315.1600.11	1.315.1601.11
PG 21	PG 21	11	40	49	10	33	1.315.2100.11	1.315.2101.11
PG 29	PG 29	11	51,5	60	14	42	1.315.2900.11	1.315.2901.11
3/8" NPT	PG 9	15	23	28,5	5	19	1.315.3800.70	1.315.3801.70
1/2" NPT	PG 13,5	13	30,5	35	7	24	1.315.1200.70	1.315.1201.70
3/4" NPT	PG 21	13	40	49	10	33	1.315.3400.70	1.315.3401.70
1" NPT	PG 29	19	51,5	60	14	42	1.315.1000.70	1.315.1001.70



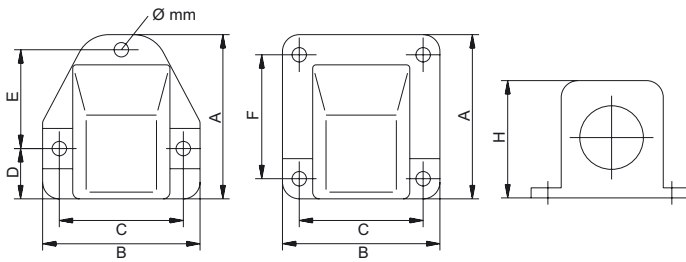

Material
Seal
Protection
Operating
Temperature
Colors

PA (Nylon)
Buna-N
IP 65
-20 °C – 80 °C (-4 °F – 176 °F)
grey RAL 7011
black RAL 9005

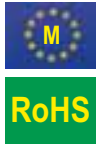

Size	Ø mm	A mm	B mm	C mm	D mm	F mm	H mm	Number grey	Number black
M 16 x 1,5	4	49	47	37	15		29,5	1.312.1600.50	1.312.1601.50
M 20 x 1,5	4	49	47	37	15	29,5	35	1.312.2000.50	1.312.2001.50
M 25 x 1,5	6	69	65	52	21	42	44	1.312.2500.50	1.312.2501.50
M 32 x 1,5	6	90	78	65	9	65	55	1.312.3200.50	1.312.3201.50
M 40 x 1,5	6	100	94	80	10	80	66	1.312.4000.50	1.312.4001.50
M 50 x 1,5	6	116	101	88	12	88,5	76	1.312.5000.50	1.312.5001.50
PG 11	4	49	47	37	15	29,5	35	1.312.1100.11	1.312.1101.11
PG 16	4	49	47	37	15	29,5	35	1.312.1600.11	1.312.1601.11
PG 21	6	69	65	52	21	42	44	1.312.2100.11	1.312.2101.11
PG 29	6	90	78	65	9	65	55	1.312.2900.11	1.312.2901.11
PG 36	6	100	94	80	10	80	66	1.312.3600.11	1.312.3601.11
PG 48	6	116	101	88	12	88,5	76	1.312.4800.11	1.312.4801.11



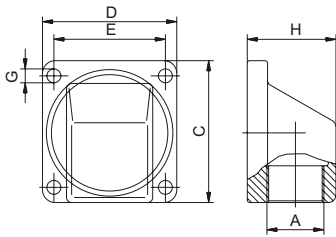

Flange elbow ZN

Material Zinc die casting
Protection IP 65

Flange elbow T

Material PA (Nylon)
Protection IP 65
Colors grey RAL 7035

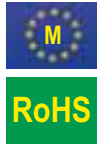

Metric threads available upon request

A	C mm	D mm	E mm	G mm	H mm	Number
Flange elbow ZN						
M 20 x 1,5	56	53	44	5,5	35	1.306.2000.50
M 25 x 1,5	65	63	54	5,5	42	1.306.2500.50
M 32 x 1,5	75	71	60	5,5	52	1.306.3200.50
M 50 x 1,5	93	89	72	6,5	69	1.306.5000.50
M 63 x 1,5	114	96	84	6,5	74	1.306.6300.50
PG						
PG 9	50	45	37	4,3	30	1.306.0900.05
PG 11	50	45	37	4,3	30	1.306.1100.05
PG 13,5	56	53	44	5,5	35	1.306.1300.05
PG 16	56	53	44	5,5	35	1.306.1600.05
PG 21	65	63	54	5,5	42	1.306.2100.05
PG 29	74	70	60	5,5	52	1.306.2900.05
PG 36	94	89	72	6,5	69	1.306.3600.05
PG 42	114	96	84	6,5	74	1.306.4200.05
PG 48	114	96	84	6,5	74	1.306.4800.05
Flange elbow T						
PG 9	50	45	37	4,3	29	1.306.0900.14
PG 11	50	45	37	4,3	29	1.306.1100.14
PG 13,5	56	53	44	5,5	35	1.306.1300.14
PG 16	56	53	44	5,5	35	1.306.1600.14
PG 21	68	68	55,5	5,5	43	1.306.2100.14
PG 29	74	70	60	5,5	52	1.306.2900.14
PG 36	93	88	72	6,5	68	1.306.3600.14



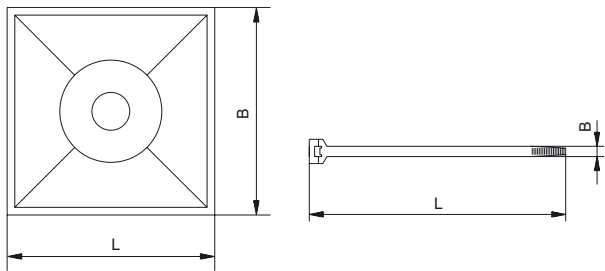

Cable Ties STN / STB

L mm	B mm	K ₂	STN	STB
			-60°C – 110°C (-76°F – 230°F)	-60°C – 110°C (-76°F – 230°F)
75	2,2	6,0	1.480.5201.00	1.480.5201.11
98	2,5	8,1	1.480.5203.00	1.480.5203.11
130	2,9	8,3	1.480.5205.00	1.480.5205.11
290	2,9	8,3	1.480.5207.00	1.480.5207.11
140	3,6	13,0	1.480.5209.00	1.480.5209.11
200	3,6	13,0	1.480.5210.00	1.480.5210.11
160	4,5	18,3	1.480.5211.00	1.480.5211.11
178	4,8	22,0	1.480.5213.00	1.480.5213.11
200	4,8	22,0	1.480.5215.00	1.480.5215.11
250	4,8	22,0	1.480.5216.00	1.480.5216.11
290	4,8	22,0	1.480.5217.00	1.480.5217.11
360	4,8	22,0	1.480.5219.00	1.480.5219.11
Base				
19	19		1.480.1919.00	1.480.1919.11
27	27		1.480.2727.00	1.480.2727.11

Cable Ties STN / STB

Material: PA (Nylon)
Colors: natural, other colors upon request (STN), black (UV resistant) (STB)



Base SN / SB

Colors: natural (SN)
black (UV resistant) (SB)

Cable Ties HDN / HDB

Material: PA (Nylon)
Colors: natural, other colors upon request (HDN), black (UV resistant) (HDB)

Cable Ties HDN / HDB

L mm	B mm	K ₂	HDN	HDB
			-60°C – 110°C (-76°F – 230°F)	-60°C – 110°C (-76°F – 230°F)
120	7,8	54,0	1.480.5221.00	1.480.5221.11
180	7,8	54,0	1.480.5223.00	1.480.5223.11
240	7,8	54,0	1.480.5225.00	1.480.5225.11
300	7,8	54,0	1.480.5226.00	1.480.5226.11
370	7,8	54,0	1.480.5227.00	1.480.5227.11
450	7,8	54,0	1.480.5229.00	1.480.5229.11
540	7,8	54,0	1.480.5231.00	1.480.5231.11
730	7,8	54,0	1.480.5233.00	1.480.5233.11
780	9,0	77,0	1.480.5234.00	1.480.5234.11
225	12,0	110,0	1.480.5235.00	1.480.5235.11
500	12,0	110,0	1.480.5237.00	1.480.5237.11
720	12,0	110,0	1.480.5239.00	1.480.5239.11
850	12,0	110,0	1.480.5241.00	1.480.5241.11
1000	12,0	110,0	1.480.5243.00	1.480.5243.11

