

HUMMEL products are available from MARYLAND METRICS

P.O.Box 261 Owings Mills, MD 21117 USA

phones: (410)358-3130 (800)638-1830 faxes: (410)358-3142 (800)872-9329

email: sales@mdmetric.com web: <http://mdmetric.com>



Setting Standards

Snapflex standard

Innovative, patented time saving conduit fitting assembly system featuring exceptional pull-out resistance. Assembly of the fittings can be accomplished from the outside of the enclosure. No threaded enclosure or lock-nuts are needed.

Assembly instructions starting on page 163.

Snapflex	Flexible conduit for Snapturn and Snapcllic-DUO
Snapturn	Corrugated conduit gland made of polyamide
Snapcllic DUO	Conduit fitting with additional seal and strain relief for the cable, for wall thicknesses 1 – 3 mm (.04" to .12")
Snapcllic-DUO-PA-W	90° snap elbow with strain relief fittings and cable clamp for corrugated conduit
Snapclip	Snap-in mounting bracket for Snapflex, 3-dimensional stacking possible
Snapform	Sheet metal elbow for conduit



Snapflex

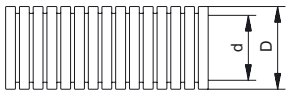

Material PA (Nylon)
 Operating Temperature -30 °C – 100 °C
 (-22 °F – 212 °F)
 Colors grey RAL 7031
 black RAL 9005



PP upon request

Size D	d mm	D mm	Number grey	Number black
16	10,7	16	1.510.1600.50	1.510.1601.50
20	14,1	20	1.510.2000.50	1.510.2001.50
25	18,3	25	1.510.2500.50	1.510.2501.50
32	24,3	32	1.510.3200.50	1.510.3201.50
40	31,2	40	1.510.4000.50	1.510.4001.50
50	39,6	50	1.510.5000.50	1.510.5001.50
63	50,6	63	1.510.6300.50	1.510.6301.50



Snapturn

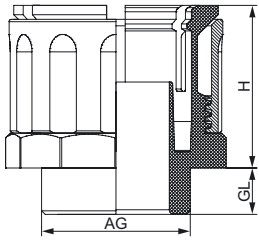

Material PA (Nylon)
 Operating Temperature -20 °C – 80 °C
 (-4 °F – 176 °F)
 Colors black

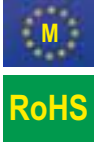

International approval pending

Size D	H mm	Panel Hole Ø mm	Fits Snapflex Conduit	Number
16	26,5	M16 x 1,5	16	1.515.1601.50
20	29	M20 x 1,5	20	1.515.2001.50
25	32	M25 x 1,5	25	1.515.2501.50
32	36	M32 x 1,5	32	1.515.3201.50
40	36	M40 x 1,5	40	1.515.4001.50
50	40	M50 x 1,5	50	1.515.5001.50

➔ Assembly instructions see page 169



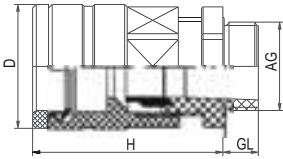

Material PA (Nylon)
 Seal Buna-N
 Operating Temperature -40 °C – 100 °C
 (-40 °F – 212 °F)



NPT threads and elongated threads available upon request

AG	GL mm	H mm	D mm			Fits Snapflex Conduit	Number		Fits SM-WS Conduit	Number
M 16 x 1,5	8	42	25	22	5 - 10	16	1.542.1601.50	5 - 10	DN 10	1.542.1610.50
M 16 x 1,5	8	42	25	22	3 - 7	16	1.542.1601.51	3 - 7	DN 10	1.542.1610.51
M 20 x 1,5	9	44	25	24				6 - 12	DN 12	1.542.2012.50
M 20 x 1,5	9	44	25	24				5 - 9	DN 12	1.542.2012.51
M 20 x 1,5	10	46	30	27	10 - 14	20	1.542.2001.50	10 - 14	DN 14	1.542.2014.50
M 20 x 1,5	10	46	30	27	7 - 12	20	1.542.2001.51	7 - 12	DN 14	1.542.2014.51
M 25 x 1,5	11	50	35	33	13 - 18	25	1.542.2501.50	13 - 16	DN 17	1.542.2517.50
M 25 x 1,5	11	50	35	33	9 - 16	25	1.542.2501.51	9 - 16	DN 17	1.542.2517.51
M 32 x 1,5	11	60	42	42	18 - 24	32	1.542.3201.50	18 - 22	DN 23	1.542.3223.50
M 32 x 1,5	11	60	42	42	13 - 20	32	1.542.3201.51	13 - 20	DN 23	1.542.3223.51
M 40 x 1,5	13	60	50	53	22 - 31	40	1.542.4001.50	22 - 28	DN 29	1.542.4029.50
M 40 x 1,5	13	60	50	53	20 - 26	40	1.542.4001.51	20 - 26	DN 29	1.542.4029.51
PG 11	8	42	25	22	5 - 10	16	1.543.1116.14	5 - 10	DN 10	1.543.1110.14
PG 11	8	42	25	22	3 - 7	16	1.543.1116.15	3 - 7	DN 10	1.543.1110.15
PG 13,5	9	44	25	24				6 - 12	DN 12	1.543.1312.14
PG 13,5	9	44	25	24				5 - 9	DN 12	1.543.1312.15
PG 16	10	46	30	27	10 - 14	20	1.543.1620.14	10 - 14	DN 14	1.543.1614.14
PG 16	10	46	30	27	7 - 12	20	1.543.1620.15	7 - 12	DN 14	1.543.1614.15
PG 21	11	50	35	33	13 - 16	25	1.543.2125.14	13 - 16	DN 17	1.543.2117.14
PG 21	11	50	35	33	9 - 16	25	1.543.2125.15	9 - 16	DN 17	1.543.2117.15
PG 29	11	60	42	42	18 - 22	32	1.543.2932.14	18 - 22	DN 23	1.543.2923.14
PG 29	11	60	42	42	13 - 20	32	1.543.2932.15	13 - 20	DN 23	1.543.2923.15
PG 36	13	60	50	53	22 - 28	40	1.543.3640.14	22 - 28	DN 29	1.543.3629.14
PG 36	13	60	50	53	20 - 16	40	1.543.3640.15	20 - 26	DN 29	1.543.3629.15



Snapclic-DUO-MS

Metr./PG

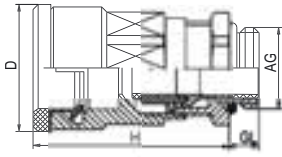

Material Nickel plated brass
 Clamping insert PA (Nylon)
 Seal Buna-N
 Operating Temperature -40 °C – 100 °C (-40 °F – 212 °F)

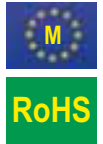

**NPT threads and elongated threads available upon request
 EMI-version available**

AG	GL mm	H mm	D mm	mm	mm	Fits Snapflex Conduit	Number	mm	Fits SM-WS Conduit	Number
M 16 x 1,5	6	38,5	23	20	5 - 10	16	1.547.1601.50	5 - 10	10	1.547.1610.50
M 16 x 1,5	6	38,5	23	20	3 - 7	16	1.547.1601.51	3 - 7	10	1.547.1610.51
M 20 x 1,5	6	39,5	25	22				6 - 12	12	1.547.2012.50
M 20 x 1,5	6	39,5	25	22				5 - 9	12	1.547.2012.51
M 20 x 1,5	6	41,5	29	24	10 - 14	20	1.547.2001.50	10 - 14	14	1.547.2014.50
M 20 x 1,5	6	41,5	29	24	7 - 12	20	1.547.2001.51	7 - 12	14	1.547.2014.51
M 25 x 1,5	7	44,5	30	30	13 - 18	25	1.547.2501.50	13 - 16	17	1.547.2517.50
M 25 x 1,5	7	44,5	30	30	9 - 16	25	1.547.2501.51	9 - 16	17	1.547.2517.51
M 32 x 1,5	8	52,5	39	40	18 - 24	32	1.547.3201.50	18 - 22	23	1.547.3223.50
M 32 x 1,5	8	52,5	39	40	13 - 20	32	1.547.3201.51	13 - 20	23	1.547.3223.51
M 40 x 1,5	8	59	45	50	22 - 31	40	1.547.4001.50	22 - 28	29	1.547.4029.50
M 40 x 1,5	8	59	45	50	20 - 26	40	1.547.4001.51	20 - 26	29	1.547.4029.51
PG 11	6	38,5	23	20	5 - 10	16	1.548.1116.01	5 - 10	10	1.548.1110.01
PG 11	6	38,5	23	20	3 - 7	16	1.548.1116.15	3 - 7	10	1.548.1110.15
PG 13,5	6	39,5	25	22				6 - 12	12	1.548.1312.01
PG 13,5	6	39,5	25	22				5 - 9	12	1.548.1312.15
PG 16	6	41,5	29	24	10 - 14	20	1.548.1620.01	10 - 14	14	1.548.1614.01
PG 16	6	41,5	29	24	7 - 12	20	1.548.1620.15	7 - 12	14	1.548.1614.15
PG 21	7	44,5	30	30	13 - 16	25	1.548.2125.01	13 - 16	17	1.548.2117.01
PG 21	7	44,5	30	30	9 - 16	25	1.548.2125.15	9 - 16	17	1.548.2117.15
PG 29	8	52,5	39	40	18 - 22	32	1.548.2932.01	18 - 22	23	1.548.2923.01
PG 29	8	52,5	39	40	13 - 20	32	1.548.2932.15	13 - 20	23	1.548.2923.15
PG 36	8	59	45	50	22 - 28	40	1.548.3640.01	22 - 28	29	1.548.3629.01
PG 36	8	59	45	50	20 - 16	40	1.548.3640.15	20 - 26	29	1.548.3629.15



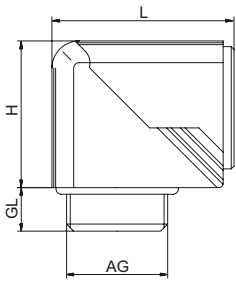

Snapcllic-PA-W

Metr./PG/NPT



Material PA (Nylon)
 O-Ring Buna-N
 Operating Temperature -20 °C – 80 °C
 (-4 °F – 176 °F)
 Colors black



AG	GL mm	H mm	L mm	R mm			Fits Snapflex Conduit	Number	Fits SM-WS Conduit	Number
M 20 x 1,5	9	30,5	38	7	7	24			DN 10	1.552.2010.50
M 25 x 1,5	11	40	53	10	10	33	20	1.552.2520.50	DN 14	1.552.2514.50
M 25 x 1,5	11	40	53	10	10	33	25	1.552.2525.50	DN 17	1.552.2517.50
M 32 x 1,5	11	51,5	64,5	14	14	42	32	1.552.3200.50	DN 23	1.552.3223.50
PG 13,5	9	30,5	38	25	7	24			DN 10	1.552.1310.14
PG 16	10	32,5	41,5	30	8	27	16	1.552.1616.14	DN 12	1.552.1612.14
PG 21	11	40	53	35	10	33	20	1.552.2120.14	DN 14	1.552.2114.14
PG 21	11	40	53,5	35	10	33	25	1.552.2125.14	DN 17	1.552.2117.14
PG 29	11	51,5	64,5	42	14	42	32	1.552.2932.14	DN 23	1.552.2923.14
1/2" NPT	13	30,5	38	25	7	24			DN 10	1.552.1210.70
3/4" NPT	13	40	53	35	10	33	20	1.552.3420.70	DN 14	1.552.3414.70
3/4" NPT	13	40	53,5	35	10	33	25	1.552.3425.70	DN 17	1.552.3417.70
1" NPT	19	51,5	64,5	42	14	42	32	1.552.1032.70	DN 23	1.552.1023.70



Snapclic-DUO-PA-W

Metr./PG

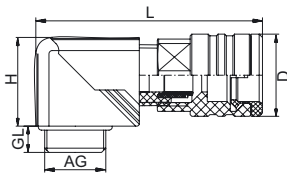

Material PA (Nylon)
 Seal Buna-N
 Operating Temperature -20°C – 80°C
 (-4°F – 176°F)

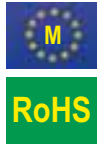

NPT threads and elongated threads available upon request

AG	GL mm	H mm	L mm	D mm	R mm	mm	mm	Fits Snapflex Conduit	Number	mm	Fits SM-WS Conduit	Number
M 20 x 1,5	9	30,5	74,5	25	7	24				6 - 12	DN 10	1.554.2012.50
M 20 x 1,5	9	30,5	74,5	25	7	24				5 - 9	DN 10	1.554.2012.51
M 25 x 1,5	11	40	93	35	10	33	13 - 18	25	1.553.2501.50	13 - 16	DN 14	1.554.2517.50
M 25 x 1,5	11	40	93	35	10	33	9 - 16	25	1.553.2501.51	9 - 16	DN 17	1.554.2517.51
M 32 x 1,5	11	51,5	110,5	42	14	42	18 - 22	32	1.553.3201.50	18 - 22	DN 23	1.554.3223.50
M 32 x 1,5	11	51,5	110,5	42	14	42	13 - 20	32	1.553.3201.51	13 - 20	DN 23	1.554.3223.51
PG 11	8	27	66,5	25	6	22	5 - 10	16	1.554.1116.14	5 - 10	DN 10	1.554.1110.14
PG 11	8	27	66,5	25	6	22	3 - 7	16	1.554.1116.15	3 - 7	DN 10	1.554.1110.15
PG 13,5	9	30,5	74,5	25	7	24				6 - 12	DN 12	1.554.1312.14
PG 13,5	9	30,5	74,5	25	7	24				5 - 9	DN 12	1.554.1312.15
PG 16	10	32,5	78	30	8	27	10 - 14	20	1.554.1620.14	10 - 14	DN 14	1.554.1614.14
PG 16	10	32,5	78	30	8	27	7 - 12	20	1.554.1620.15	7 - 12	DN 14	1.554.1614.15
PG 21	11	40	93	35	10	33	13 - 16	25	1.554.2125.14	13 - 16	DN 17	1.554.2117.14
PG 21	11	40	93	35	10	33	9 - 16	25	1.554.2125.15	9 - 16	DN 17	1.554.2117.15
PG 29	11	51,5	110,5	42	14	42	18 - 22	32	1.554.2932.14	18 - 22	DN 23	1.554.2923.14
PG 29	11	51,5	110,5	42	14	42	13 - 20	32	1.554.2932.15	13 - 20	DN 23	1.554.2923.15



Snapclip / Snapform

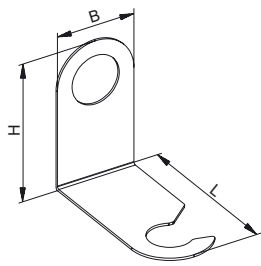
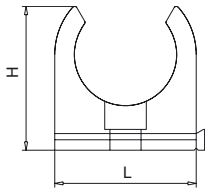

Material

PA (Nylon) /
Special steel

Operating
Temperature
Colors

-30 °C – 100 °C
(-22 °F – 212 °F)
grey RAL 7031
black RAL 9005



PP upon request

Fits to Snapflex	H mm	L mm	B mm	Number grey	Number black
Snapclip					
16	25	21		1.730.1600.50	1.730.1601.50
20	30	28		1.730.2000.50	1.730.2001.50
25	34	34		1.730.2500.50	1.730.2501.50
32	40	42		1.730.3200.50	1.730.3201.50
40	50	51		1.730.4000.50	1.730.4001.50
50	60	62		1.730.5000.50	1.730.5001.50
63	72	76		1.730.6300.50	1.730.6301.50
Snapform					
16	50	66	30		1.318.1600.04
20	60	75	34		1.318.2000.04
25	65	80	39		1.318.2500.04
32	75	90	46		1.318.3200.04
40	95	105	55		1.318.4000.04
50	115	125	66		1.318.5000.04
63	145	165	82		1.318.6300.04

