

PROPELLER T-NUTS -Round Base

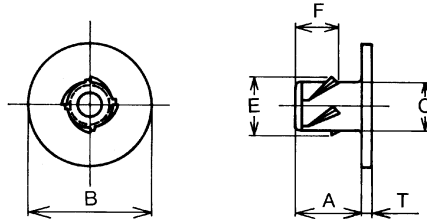

Inch Thread Series

Part Number	Thread Size	A Barrel Height	B	C	E min.	F min.	T	Weight 1M Pieces Lbs.
SN-04801	# 10-24	5/16	.71	.234	.285	.13	.039	5.7
SN-04802	# 10-32	5/16	.71	.234	.285	.13	.039	5.7
SN-04803	# 10-24	7/16	.71	.250	.30	.13	.039	6.2
SN-06301	1/4-20	5/16	.75	.297	.34	.16	.047	7.5
SN-06302	1/4-20	7/16	.75	.297	.34	.16	.047	8.6
SN-06303	1/4-20	1/2	.75	.297	.34	.16	.047	9.3
SN-06313	1/4-20	1/2	.63	.297	.34	.16	.047	7.7
SN-06304	1/4-20	9/16	.75	.297	.34	.16	.047	9.7
SN-07905	5/16-18	3/8	.88	.375	.40	.16	.055	12.7
SN-07901	5/16-18	5/8	.88	.375	.40	.25	.055	16
SN-09501	3/8-16	7/16	1.00	.453	.50	.19	.071	22