

Self-Aligning Ball Bearings

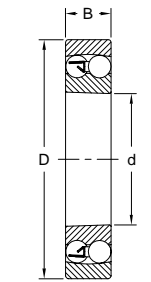

Tapered & Straight Bores 1200 & 1300 Series



Tapered Bore

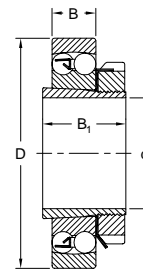

Tapered Bore Adapter Mounted
Uses H200 Adapters
or SNW Series

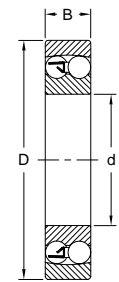

Straight Bore

1200 and 1200 K Series

Straight Bore Bearing Part No. *	Taper Bore Bearing Part No. *	Dimensions (mm)							Basic Load Ratings in kN		Max. rpm		Weight kg	
		d	D	B	r	d ₁ *		B ₁	Dynamic	Static	Grease	Oil	Bearing	Sleeve
						mm	in		C	C ₀				
1205	1205K	25	52	15	1.0	20	5/8, 3/4	26	12.2	3.35	13000	16000	0.1	0.1
1206	1206K	30	62	16	1.0	25	7/8, 1	27	15.6	4.65	11000	14000	0.2	0.1
1207	1207K	35	72	17	1.1	30	1-1/8, 1-3/16	29	16.0	5.20	9500	12000	0.3	0.1
1208	1208K	40	80	18	1.1	35	1-1/4, 1-3/8	31	19.3	6.55	8500	10000	0.4	0.2
1209	1209K	45	85	19	1.1	40	1-1/2	33	22.0	7.35	7500	9000	0.5	0.2
1210	1210K	50	90	20	1.1	45	1-11/16, 1-3/4	35	22.8	8.15	7000	8500	0.5	0.3
1211	1211K	55	100	21	1.5	50	1-15/16, 2	37	27.0	10.0	6300	7500	0.7	0.3
1212	1212K	60	110	22	1.5	55	2-1/8, 2-3/16	38	30.0	11.6	5600	6700	0.9	0.3
1213	1213K	65	120	23	1.5	60	2-1/4	40	31.0	12.5	5300	6300	1.2	0.4
1214	1214K	70	125	24	1.5	—	—	—	34.5	13.7	5000	6000	1.3	—
1215	1215K	75	130	25	1.5	65	2-7/16, 2-1/2	43	39.0	15.6	4800	5600	1.4	0.7
1216	1216K	80	140	26	2.0	70	2-11/16, 2-3/4	46	40.0	17.0	4300	5000	1.7	0.9
1217	1217K	85	150	28	2.0	75	2-15/16, 3	50	49.0	20.4	4000	4800	2.1	1.0
1218	1218K	90	160	30	2.0	80	3-3/16, 3-1/4	52	57.0	23.6	3800	4500	2.6	1.2
1219	1219K	95	170	32	2.1	85	3-3/8	55	64.0	27.0	3400	4000	3.2	1.4
1220	1220K	100	180	34	2.1	90	3-7/16, 3-1/2	58	69.5	30.0	3200	3800	3.8	1.5
1222	1222K	110	200	38	2.1	100	3-15/16, 4	63	88.0	38.0	2800	3400	5.2	1.9

1300 Series (for Taper Bore see H300 Series Adapters)

1305	1305K	25	62	17	1.1	20	5/8, 3/4	29	18.0	5.0	11000	14000	0.3	0.1
1306	1306K	30	72	19	1.1	25	7/8, 1	31	21.2	6.3	9000	11000	0.4	0.1
1307	1307K	35	80	21	1.5	30	1-1/8, 1-3/16	35	25.0	8.0	8000	9500	0.5	0.1
1308	1308K	40	90	23	1.5	35	1-1/4	36	29.0	9.6	7000	8500	0.7	0.2
1309	1309K	45	100	25	1.5	40	1-1/2	39	38.0	12.9	6300	7500	1.0	0.2
1310	1310K	50	110	27	2.0	45	1-11/16, 1-3/4	42	41.5	14.3	5600	6700	1.3	0.3
1311	1311K	55	120	29	2.0	50	1-15/16, 2	45	51.0	18.0	5000	6000	1.6	0.3
1312	1312K	60	130	31	2.1	55	2-1/8, 2-3/8	47	57.0	20.8	4500	5300	2.0	0.4
1313	1313K	65	140	33	2.1	60	2-1/4	50	62.0	22.8	4300	5000	2.5	0.5
1314	—	70	150	35	2.1	—	—	—	75.0	27.5	4000	4800	3.1	—
1315	1315K	75	160	37	2.1	65	2-7/16, 2-1/2	55	80.0	30.0	3600	4300	3.7	0.8
1316	1316K	80	170	39	2.1	70	2-11/16, 2-3/4	59	88.0	32.5	3400	4000	4.3	1.0
1317	1317K	85	180	41	3.0	75	2-15/16, 3	63	98.0	38.0	3200	3800	5.1	1.2
1318	1318K	90	190	43	3.0	80	3-3/16, 3-1/4	65	108.0	43.0	3000	3600	6.0	1.4

*Note: Part No. Suffix C3W33 (C3 = Internal Clearance, W33 = Lube Groove) will be provided unless otherwise specified.
K = Taper Bore, without K = straight bore. For Taper Bore (K) bearings, use the H200 Series adapters.

Self-Aligning Ball Bearings



2200 & 2300 Series

Tapered & Straight Bores

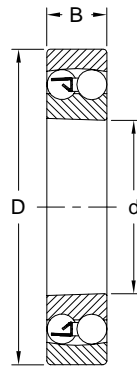

Tapered Bore

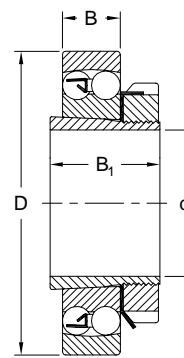

Tapered Bore Adapter Mounted
Uses H200 Adapters
or SNW Series

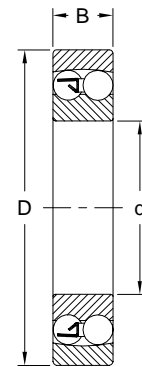

Straight Bore

2200 Series (for Taper Bore see H300 Series Adapters)

Straight Bore Bearing Part No. *	Taper Bore Bearing Part No. *	Dimensions (mm)							Basic Load Ratings in kN		Max. rpm		Weight kg	
		d	D	B	r	d ₁ *		B ₁	C	C ₀	Grease	Oil	Bearing	Sleeve
						mm	in							
2205	2205K	25	52	18	1.0	20	5/8, 3/4	29	17.0	4.4	12000	15000	0.2	0.1
2206	2206K	30	62	20	1.0	25	7/8, 1	31	25.5	6.9	9500	12000	0.3	0.1
2207	2207K	35	72	23	1.1	30	1-1/8, 1-3/16	35	32.0	9.0	8000	9500	0.4	0.1
2208	2208K	40	80	23	1.1	35	1-1/4	36	31.5	9.5	7500	9000	0.5	0.2
2209	2209K	45	85	23	1.1	40	1-1/2	39	28.0	9.0	7000	8500	0.5	0.2
2210	2210K	50	90	23	1.1	45	1-11/16, 1-3/4	42	28.0	9.5	6700	8000	0.6	0.3
2211	2211K	55	100	25	1.5	50	1-15/16, 2	45	39.0	12.7	5600	6700	0.8	0.3
2212	2212K	60	110	28	1.5	55	2-1/8, 2-3/8	47	47.5	16.6	5300	6300	1.1	0.4
2213	2213K	65	120	31	1.5	60	2-1/4	50	57.0	19.3	4500	5300	1.4	0.5
2214	—	70	125	31	1.5	—	—	—	44.0	17.0	4800	5600	1.6	—
2215	2215K	75	130	31	1.5	65	2-7/16, 2-1/2	55	44.0	18.0	4500	5300	1.7	0.9
2216	2216K	80	140	33	2.0	70	2-11/16, 2-3/4	59	51.0	21.2	4300	5000	2.1	1.0
2217	2217K	85	150	36	2.0	75	2-15/16, 3	63	58.5	23.6	4000	4800	2.6	1.2
2218	2218K	90	160	40	2.0	80	3-3/16, 3-1/4	65	71.0	28.5	3600	4300	3.3	1.4
2220	2220K	100	180	46	2.1	90	—	71	98.0	40.5	3200	3800	5.2	1.7
2222	2222K	110	200	53	2.1	100	—	77	124.0	52.0	2800	3400	7.1	2.2

2300 Series (for Taper Bore see H2300 Series Adapters)

2305	2305K	25	62	24	1.1	20	5/8, 3/4	35	24.5	6.5	10000	13000	0.4	0.1
2306	2306K	30	72	27	1.1	25	7/8, 1	38	31.5	8.6	8500	10000	0.6	0.1
2307	2307K	35	80	31	1.5	30	1-1/8, 1-3/16	43	39.0	11.2	7500	9000	0.7	0.2
2308	2308K	40	90	33	1.5	35	1-1/4	46	45.0	13.4	6700	8000	1.0	0.2
2309	2309K	45	100	36	1.5	40	1-1/2	50	54.0	16.3	6000	7000	1.3	0.3
2310	2310K	50	110	40	2.0	45	1-11/16, 1-3/4	55	64.0	20.0	5300	6300	1.8	0.4
2311	2311K	55	120	43	2.0	50	1-15/16, 2	59	75.0	23.6	4800	5600	2.3	0.4
2312	2312K	60	130	46	2.1	55	2-1/8, 2-3/8	62	86.5	28.0	4300	5000	2.8	0.5
2313	2313K	65	140	48	2.1	60	2-1/4	65	95.0	32.5	4000	4800	3.4	0.6
2314	—	70	150	51	2.1	—	—	—	110.0	37.5	3600	4300	4.2	—
2315	2315K	75	160	55	2.1	65	2-7/16, 2-1/2	73	122.0	42.5	3400	4000	5.2	1.1
2316	2316K	80	170	58	2.1	70	2-11/16, 2-3/4	78	137.0	48.0	3200	3800	6.4	1.3
2317	2317K	85	180	60	3.0	75	2-15/16, 3	82	140.0	51.0	3000	3600	7.5	1.5
2318	2318K	90	190	64	3.0	80	3-3/16, 3-1/4	86	153.0	57.0	2800	3400	8.9	1.7

*Note: Part No. Suffix C3W33 (C3 = Internal Clearance, W33 = Lube Groove) will be provided unless otherwise specified.

K = Taper Bore, without K = straight bore. For Taper Bore (K) bearings, use the H300 or H2300 Series adapters.

Spherical Roller Bearings



222 Series

Tapered & Straight Bores

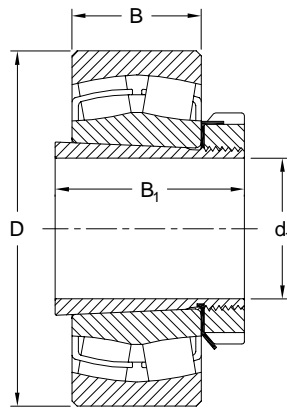

Tapered Bore
Adapter Mounted
Uses H300 & H3100 Adapters
or SNW

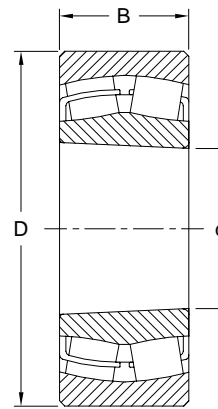

Tapered Bore

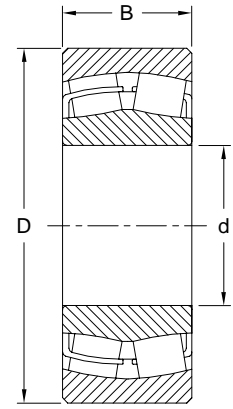

Straight Bore

Taper Bore Bearing Part No. *	Straight Bore Bearing Part No. *	Dimensions (mm)							Basic Load Ratings in kN		Max. rpm		Weight kg	
		d	D	B	r	d ₁ *		B ₁	C	C ₀	Grease	Oil	Bearing	Sleeve
						mm	in							
22205K	22205	25	52	18	1.0	20	3/4	29	35	35	9000	12000	0.2	0.1
22206K	22206	30	62	20	1.0	25	15/16, 1	31	48	52	7500	9500	0.2	0.1
22207K	22207	35	72	23	1.1	30	1-3/16	35	67	73	6300	8000	0.4	0.1
22208K	22208	40	80	23	1.1	35	—	36	73	81	6000	7500	0.5	0.2
22209K	22209	45	85	23	1.1	40	1-7/16, 1-1/2	39	77	88	5600	7000	0.5	0.2
22210K	22210	50	90	23	1.1	45	1-11/16, 1-3/4	42	84	100	5300	6700	0.6	0.3
22211K	22211	55	100	25	1.5	50	1-15/16, 2	45	115	137	4500	5600	0.8	0.3
22212K	22212	60	110	28	1.5	55	—	47	122	146	4000	5000	1.1	0.4
22213K	22213	65	120	31	1.5	60	2-3/16, 2-1/4	50	148	183	3600	4500	1.4	0.5
22214K	22214	70	125	31	1.5	60	—	52	148	185	3600	4500	1.5	0.7
22215K	22215	75	130	31	1.5	65	2-7/16, 2-1/2	55	156	205	3400	4300	1.6	0.9
22216K	22216	80	140	33	2.0	70	2-11/16, 2-3/4	59	175	225	3200	4000	2.0	1.0
22217K	22217	85	150	36	2.0	75	2-15/16, 3	63	210	270	3000	3800	2.5	1.2
22218K	22218	90	160	40	2.0	80	3-3/16, 3-1/4	65	250	340	2600	3400	3.2	1.4
22219K	22219	95	170	43	2.1	85	—	68	280	370	2400	3200	3.9	1.6
22220K	22220	100	180	46	2.1	90	3-7/16, 3-1/2	71	310	410	2200	3000	4.7	1.7
22222K	22222	110	200	53	2.1	100	3-15/16, 4	77	405	550	2000	2800	6.7	2.2
22224K	22224	120	215	58	2.1	110	4-3/16, 4-1/4	88	465	665	1800	2400	8.4	2.7
22226K	22226	130	230	64	3.0	115	4-7/16, 4-1/2	92	545	800	1700	2200	10.5	3.7
22228K	22228	140	250	68	3.0	125	4-15/16, 5	97	605	900	1600	2000	13.4	4.4
22230K	22230	150	270	73	3.0	135	5-3/16, 5-1/4	111	730	1075	1500	1900	16.9	5.5
22232K	22232	160	290	80	3.0	140	5-7/16, 5-1/2	119	860	1285	1400	1800	21.7	7.7
22234K	22234	170	310	86	4.0	150	5-15/16, 6	122	975	1450	1300	1700	28.5	8.4
22236K	22236	180	320	86	4.0	160	6-7/16, 6-1/2	131	1000	1550	1300	1700	29.5	9.5
22238K	22238	190	340	92	4.0	170	6-15/16, 7	141	1100	1700	1200	1600	36.5	11.0
22240K	22240	200	360	98	4.0	180	7-3/16	150	1250	1900	1100	1500	43.5	12.0
22244K	22244	220	400	108	4.0	200	7-15/16, 8	161	1500	2300	950	1300	60.0	14.7

*Note: Part No. Suffix C3W33 (C3 = Internal Clearance, W33 = Lube Groove) will be provided unless otherwise specified.

K = Taper Bore, without K = straight bore. For Taper Bore (K) bearings, use the H300 or H3100 Series adapters or SNW.

Spherical Roller Bearings



223 Series

Tapered & Straight Bores

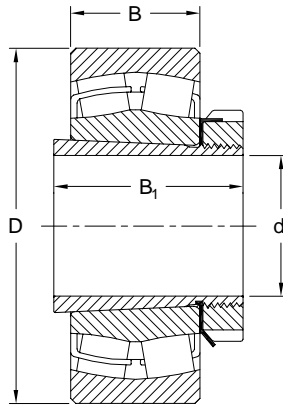

Tapered Bore
Adapter Mounted
Uses H2300 Adapters

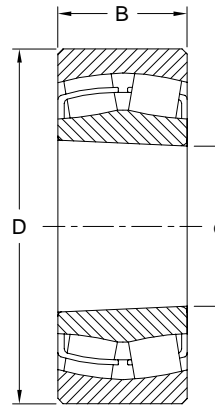

Tapered Bore

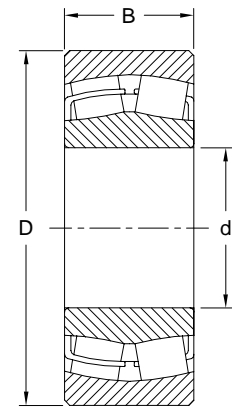

Straight Bore

Taper Bore Bearing Part No. *	Straight Bore Bearing Part No. *	Dimensions (mm)							Basic Load Ratings in kN		Max. rpm		Weight kg	
		d	D	B	r	d ₁ *		B ₁	C	C ₀	Grease	Oil	Bearing	Sleeve
						mm	in							
22308K	22308	40	90	33	1.5	35	1-1/4, 1-3/8	46	112	120	4500	5600	1.0	0.2
22309K	22309	45	100	36	1.5	40	1-1/2	50	135	155	3800	4800	1.4	0.3
22310K	22310	50	110	40	2	45	1-11/16, 1-3/4	55	175	200	3400	4300	1.9	0.4
22311K	22311	55	120	43	2	50	1-15/16, 2	59	195	230	3200	4000	2.4	0.4
22312K	22312	60	130	46	2.1	55	2-1/8, 2-3/16	62	230	280	3000	3800	3.0	0.5
22313K	22313	65	140	48	2.1	60	2-1/4	65	250	300	2600	3400	3.6	0.6
22314K	22314	70	150	51	2.1	60	—	86	310	380	2400	3200	4.3	0.9
22315K	22315	75	160	55	2.1	65	2-7/16, 2-1/2	73	340	430	2200	3000	5.3	1.1
22316K	22316	80	170	58	2.1	70	2-11/16, 2-3/4	78	370	450	2000	2800	6.2	1.3
22317K	22317	85	180	60	3	75	2-15/16, 3	82	420	515	1900	2600	7.3	1.5
22318K	22318	90	190	64	3	80	3-3/16, 3-1/4	86	475	600	1800	2400	8.6	1.7
22319K	22319	95	200	67	3	85	3-3/8	90	515	670	1800	2400	10.0	1.9
22320K	22320	100	215	73	3	90	3-7/16, 3-1/2	97	600	800	1700	2200	13.0	2.2
22322K	22322	110	240	80	3	100	3-15/16, 4	105	720	960	1600	2000	18.0	2.8
22324K	22324	120	260	86	3	110	4-3/16	112	840	1110	1400	1800	22.0	3.2
22326K	22326	130	280	93	4	115	4-7/16, 4-1/2	121	970	1300	1300	1700	28.5	4.6
22328K	22328	140	300	102	4	125	4-15/16, 5	131	1120	1550	1100	1500	34.5	5.5
22330K	22330	150	320	108	4	135	5-3/16	139	1250	1750	1000	1400	41.5	6.6
22332K	22332	160	340	114	4	140	5-7/16, 5-1/2	147	1375	1950	950	1300	50.0	9.2
22334K	22334	170	360	120	4	150	5-15/16, 6	157	1540	2150	950	1300	58.5	10.0
22336K	22336	180	380	126	4	160	6-7/16, 6-1/2	161	1725	2440	900	1200	69.0	11.0
22338K	22338	190	400	132	5	170	6-15/16, 7	169	1860	2640	850	1100	8.0	12.5
22340K	22340	200	420	138	5	180	7-3/16	176	2010	2900	850	1100	92.5	14.0

*Note: Part No. Suffix C3W33 (C3 = Internal Clearance, W33 = Lube Groove) will be provided unless otherwise specified.

K = Taper Bore, without K = straight bore. For Taper Bore (K) bearings, use the H2300 Series adapters.

Spherical Roller Bearings



230 Series

Tapered and Straight Bores

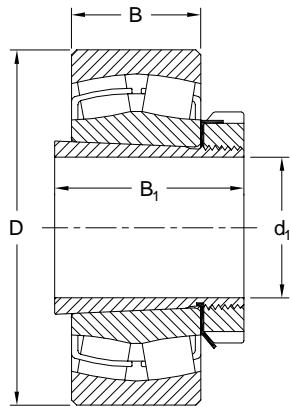

Tapered Bore
Adapter Mounted
Uses H3000 Adapters

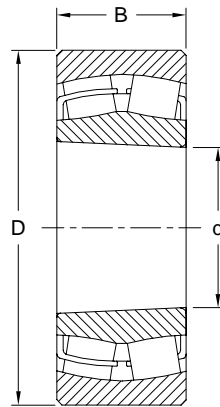

Tapered Bore

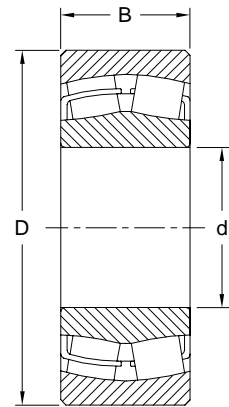

Straight Bore

Taper Bore Bearing Part No. *	Straight Bore Bearing Part No. *	Dimensions (mm)						Basic Load Ratings in kN		Max. rpm		Weight kg	
		d	D	B	d ₁ *		B ₁	C	C ₀	Grease	Oil	Bearing	Sleeve
					mm	in							
23024K	23024	120	180	46	110	4-3/16, 4-1/4	72	300	500	2000	2800	3.9	2.0
23026K	23026	130	200	52	115	4-7/16, 4-1/2	80	370	600	1900	2600	5.6	2.9
23028K	23028	140	210	53	125	4-15/16, 5	82	395	675	1800	2400	6.0	3.2
23030K	23030	150	225	56	135	5-3/16, 5-1/4	87	435	745	1700	2200	7.3	3.9
23032K	23032	160	240	60	140	5-7/16, 5-1/2	93	500	870	1700	2200	8.9	5.2
23034K	23034	170	260	67	150	5-15/16, 6	101	620	1050	1600	2000	12.1	6.0
23036K	23036	180	280	74	160	6-7/16, 6-1/2	109	720	1240	1400	1800	15.8	6.9
23038K	23038	190	290	75	170	6-15/16, 7	112	750	1340	1300	1700	16.8	7.5
23040K	23040	200	310	82	180	7-3/16	120	875	1525	1200	1600	21.5	9.2
23044K	23044	220	340	90	200	7-15/16, 8	126	1040	1850	1100	1400	31.0	10.5
23048K	23048	240	360	92	220	8-7/16, 9	133	1125	2075	1000	1300	33.9	13.0
23052K	23052	260	400	104	240	9-7/16, 9-1/2	145	1400	2500	800	1100	49.0	16.0
23056K	23056	280	420	106	260	9-15/16, 10-1/2	152	1500	2800	800	1000	52.5	17.7
23060K	23060	300	460	118	280	10-15/16, 11	168	1890	3500	720	940	70.0	22.8
23064K	23064	320	480	121	300	11-7/16, 12	171	1960	3850	680	880	77	24.6
23068K	23068	340	520	133	320	12-7/16, 12-1/2	187	2310	4550	630	820	100	28.7
23072K	23072	360	540	134	340	12-15/16, 13-1/2	188	2370	4700	590	770	110	30.5
23076K	23076	380	560	135	360	13-15/16, 14	193	2500	5150	550	720	115	35.8
23080K	23080	400	600	148	380	15	210	2980	6050	520	680	140	41.3
23084K	23084	420	620	150	400	15-3/4	212	3100	6400	490	640	150	43.7
23088K	23088	440	650	157	410	16-1/2	228	3300	6850	470	610	175	65.2
23092K	23092	460	680	163	430	17	234	3600	7450	450	580	200	69.5
23096K	23096	480	700	165	450	18	237	3650	770	420	550	210	73.3

*Note: Part No. Suffix C3W33 (C3 = Internal Clearance, W33 = Lube Groove) will be provided unless otherwise specified.

K = Taper Bore, without K = straight bore. For Taper Bore (K) bearings, use the H3000 Series adapters.

Spherical Roller Bearings



231 Series

Tapered and Straight Bores

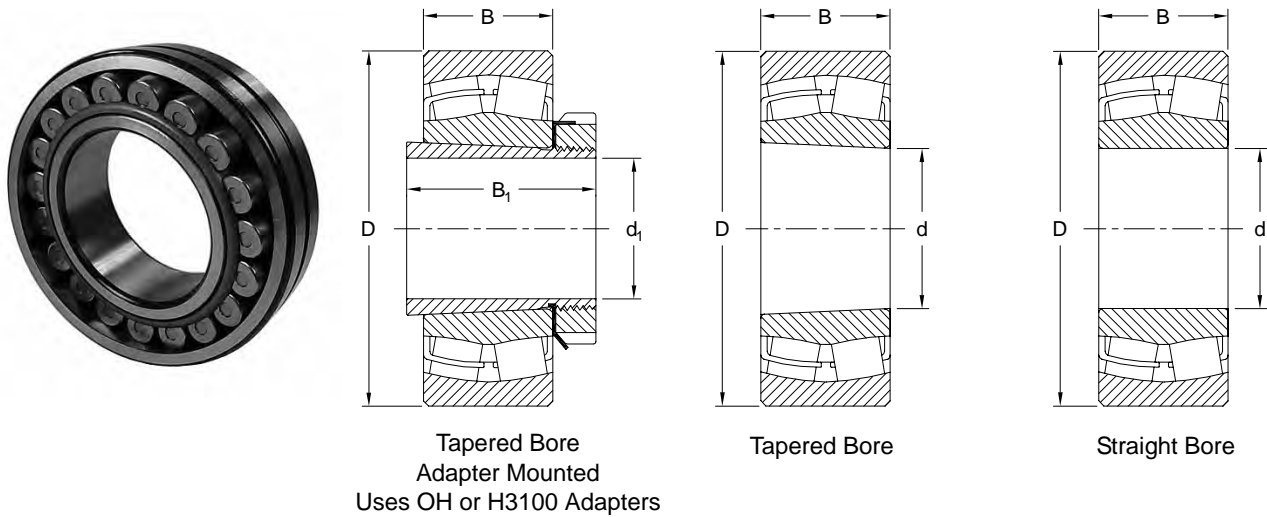

Taper Bore Bearing Part No. *	Straight Bore Bearing Part No. *	Dimensions (mm)						Basic Load Ratings in kN		Max. rpm		Weight kg	
		d	D	B	d ₁ *		B ₁	C	C ₀	Grease	Oil	Bearing	Sleeve
					mm	in							
23134K	23134	170	280	88	150	5-15/16, 6	122	890	1490	1200	1600	20.6	8.4
23136K	23136	180	300	96	160	6-7/16, 6-1/2	131	1040	1750	1100	1500	25.9	9.5
23138K	23138	190	320	104	170	6-15/16, 7	141	1200	2050	1000	1400	32.6	11.0
23140K	23140	200	340	112	180	7-3/16	150	1350	2350	900	1200	42.7	12.0
23144K	23144	220	370	120	200	7-15/16, 8	161	1550	2700	850	1100	54.4	15.0
23148K	23148	240	400	128	220	8-7/16, 9	172	1750	3100	800	1050	66.4	18.0
23152K	23152	260	440	144	240	9-7/16, 9-1/2	190	2200	3800	730	800	92.9	22.5
23156K	23156	280	460	146	260	9-15/16, 10-1/2	195	2250	4200	650	700	99.5	25.0
23160K	23160	300	500	160	280	10-15/16, 11	208	2800	5000	600	750	130.0	30.0
23164K	23164	320	540	176	300	11-7/16, 12	226	3200	5900	550	700	171.0	35.0
23168K	23168	340	580	190	320	12-7/16, 12-1/2	254	3600	6600	520	680	210	49.5
23172K	23172	360	600	192	340	12-15/16, 13-1/2	259	3750	7050	490	630	215	54.2
23176K	23176	380	620	194	360	13-15/16, 14	264	3900	7500	450	590	230	61.7
23180K	23180	400	650	200	380	15	272	4200	8050	430	560	265	70.6
23184K	23184	420	700	224	400	15-3/4	304	5200	9950	410	530	350	84.2
23188K	23188	440	720	226	410	16-1/2	307	5200	10000	390	500	355	104.0
23192K	23192	460	760	240	430	17	326	5700	11400	360	470	435	116.0
23196K	23196	480	790	248	450	18	335	6200	12300	350	450	480	133.0

*Note: Part No. Suffix C3W33 (C3 = Internal Clearance, W33 = Lube Groove) will be provided unless otherwise specified.

K = Taper Bore, without K = straight bore. For Taper Bore (K) bearings, use the H3100 Series adapters.

Spherical Roller Bearings



232 Series

Tapered and Straight Bores

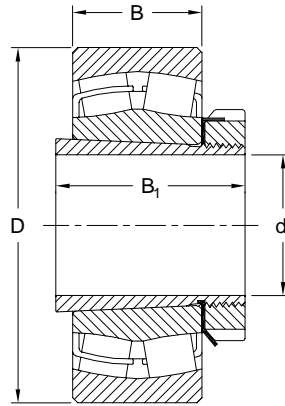

Tapered Bore
Adapter Mounted
Uses OH3200 Adapters

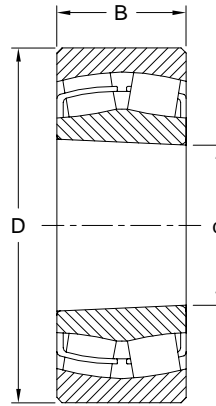

Tapered Bore

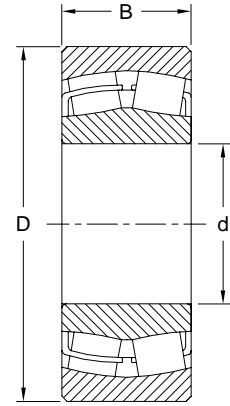

Straight Bore

Taper Bore Bearing Part No. *	Straight Bore Bearing Part No. *	Dimensions (mm)						Basic Load Ratings in kN		Max. rpm		Weight kg	
		d	D	B	d ₁ *		B ₁	Dynamic	Static	Grease	Oil	Bearing	Sleeve
					mm	in		C	C ₀				
23252K	23252	260	480	174	240	9-7/16, 9-1/2	208	2760	4700	660	860	140	21.0
23256K	23256	280	500	176	260	9-15/16, 10-1/2	221	2930	5150	610	790	150	27.0
23260K	23260	300	540	192	280	10-15/16, 11	240	3450	6000	560	730	190	34.1
23264K	23264	320	580	208	300	11-7/16, 12	258	4000	7050	520	680	240	39.3
23268K	23268	340	620	224	320	12-7/16, 12-1/2	288	4450	8000	490	630	295	54.6
23272K	23272	360	650	232	340	12-15/16, 13-1/2	299	4850	8700	450	590	335	60.6
23276K	23276	380	680	240	360	13-15/16, 14	310	5200	9650	430	550	375	69.6
23280K	23280	400	720	256	380	15	328	5850	10600	400	520	450	75.2
23284K	23284	420	760	272	400	15-3/4	352	6550	12000	380	490	535	94.0
23288K	23288	440	790	280	410	16-1/2	361	6900	12800	360	470	590	118.0
23292K	23292	460	830	296	430	17	382	7750	14500	340	440	690	132.0
23296K	23296	480	870	310	450	18	397	8300	15500	320	420	790	152.0

*Note: Part No. Suffix C3W33 (C3 = Internal Clearance, W33 = Lube Groove) will be provided unless otherwise specified.

K = Taper Bore, without K = straight bore. For Taper Bore (K) bearings, use the OH3200 Series adapters.