

RAMPA Knock-in Inserts type TS are knocked into a pre-drilled hole. The knurled shank prevents the nut from turning.

RAMPA Knock-in Inserts type TSBZ are zinc die casts. The inserts are knocked into a pre-drilled hole. The teeth prevent the nut from turning.

Threads available in UNC. Sizes not included in our range can be requested.

Maryland Metrics
<http://mdmetric.com>



RAMPA Knock-in Inserts type TS

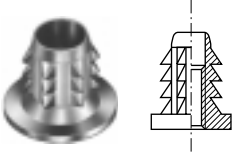

RAMPA Knock-in Inserts type TSBZ

XXX = available from stock

Type TS Article No.	Rim Ø	Shank Ø	Total Length	Internal Thread	Kilos per 1000	Steel plain	Steel zinc plated ¹⁾	Brass plain ²⁾	Stainless 1.4104 ³⁾	Stainless 1.4305 ⁴⁾
021 308 ...	8	5,5	8	M 3	1,2	XXX	XXX	XXX		
021 455 ...	8	5,5	5,5	M 4	0,8	XXX	XXX			
021 408 ...	8	5,5	8	M 4	0,9	XXX	XXX	XXX	XXX	XXX
021 506 ...	10	6,5	6,6	M 5	1,3	XXX	XXX			
021 510 ...	10	6,5	10	M 5	1,5	XXX	XXX	XXX	XXX	XXX
021 607 ...	12	8,5	7,7	M 6	3,1	XXX	XXX	XXX		
021 612 ...	12	8,5	12	M 6	3,3	XXX	XXX	XXX	XXX	XXX
021 812 ...	15	10,5	12	M 8	4,8	XXX	XXX	XXX	XXX	XXX
021 912 ...	18	12,5	12	M 10	6,8				XXX	XXX
021 912 ...	18,5	12,5	12	M 10	6,8	XXX	XXX	XXX		

↑ Please complete in order
¹⁾ 001 for steel zinc plated
²⁾ 01 for brass plain
³⁾ 02 for stainless steel 1.4104
⁴⁾ 03 for stainless steel 1.4305

XXX = available from stock

Type TSBZ Article No.	Rim Ø	Shank Ø	Total Length	Internal Thread	Drill Hole Ø	Kilos per 1000	Die Casting yellow zinc plated
451 308 092	8,5	6	8	M 3	4,1- 4,5	0,7	XXX
451 409 092	10,5	8	9,5	M 4	5,6- 6,0	1,6	XXX
451 411 092	10,5	8	11,5	M 4	5,6- 6,0	1,8	XXX
451 512 092	12,5	10	12	M 5	7,1- 7,5	3,1	XXX
451 515 092	12,5	10	15	M 5	7,1- 7,5	3,5	XXX
451 610 092	16	12	10,5	M 6	8,6- 9,0	4,2	XXX
451 612 092	14,5	12	12,5	M 6	8,6- 9,0	4,6	XXX
451 615 092	14,5	12	15,5	M 6	8,6- 9,0	5,2	XXX
451 813 092	19	13	13,5	M 8	9,6-10,0	5,6	XXX
451 815 092	19	13	15,5	M 8	9,6-10,0	5,9	XXX
451 820 092	25	13	20,5	M 8	9,6-10,0	8,5	XXX
451 823 092	19	13	23	M 8	9,6-10,0	10,0	XXX