

**Stainless Steel 316**  
(contains Molybden)

Flat head  
Semi-hexagonal shank  
Open

extra high  
corrosion resistance



**HUPO**

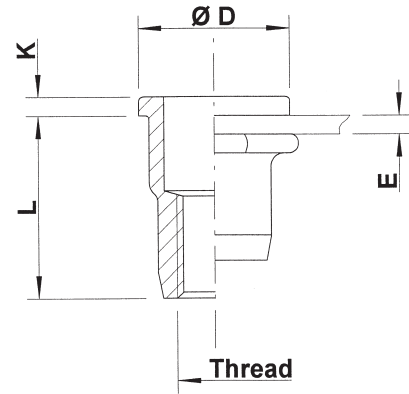
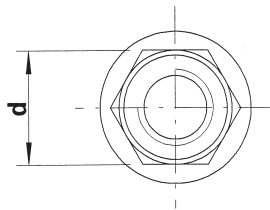
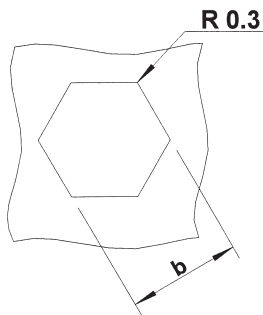

THREAD	TYPE	E = grip	L	b <sup>+0,1</sup> = hex hole	d = hex shank	D	K	kg/1000	ORDER CODE
*M5	HUPO30	0,5-3,0	11,5	7,0	7,0	10,0	1,0	1,8	555 500
M6	HUPO30	0,5-3,0	14,5	9,0	9,0	12,0	1,5	4,0	556 460
M8	HUPO30	0,5-3,0	16,0	11,0	11,0	15,0	1,5	6,1	558 250

Availability: please contact our Sales Department

\*M5: in progress

All dimensions in mm  
Technical data subject to modification

