

● Steel

Flat head
Hexagonal shank
Closed

with seal
under the head



Zinktop (A)
Zinc plated, yellow passivated (B)

HX

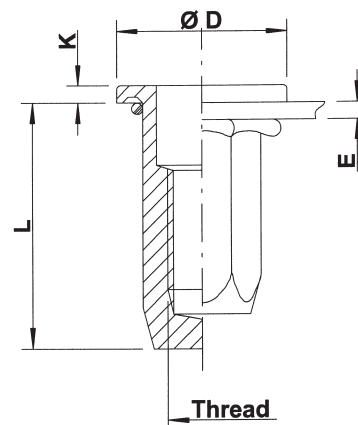
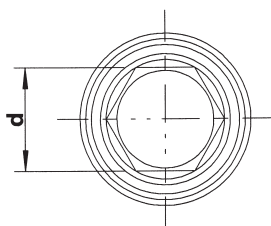
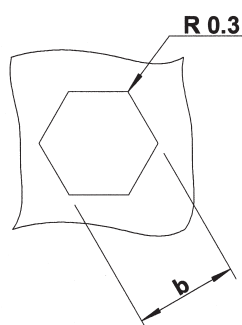

THREAD	TYPE	E = grip	L	b ^{+0,1} = hex hole	d = hex shank	D	K	kg/1000	ORDER CODE (A)	ORDER CODE (B)
M5	HX3001	0,5-3,0	19,0	7,0	7,0	12,5	1,5	4,3	525 925*	525 916*
M6	HX3001	0,5-3,0	21,5	9,0	9,0	15,0	1,5	8,0	526 942	526 920
M8	HX3001	0,5-3,0	26,7	11,0	11,0	20,0	2,0	14,8	528 935	528 924

* Minimum order quantity required after depletion of stock

All dimensions in mm
Technical data subject to modification

Technical information about seal: see page 56

